

2011 KCDA CATALOG

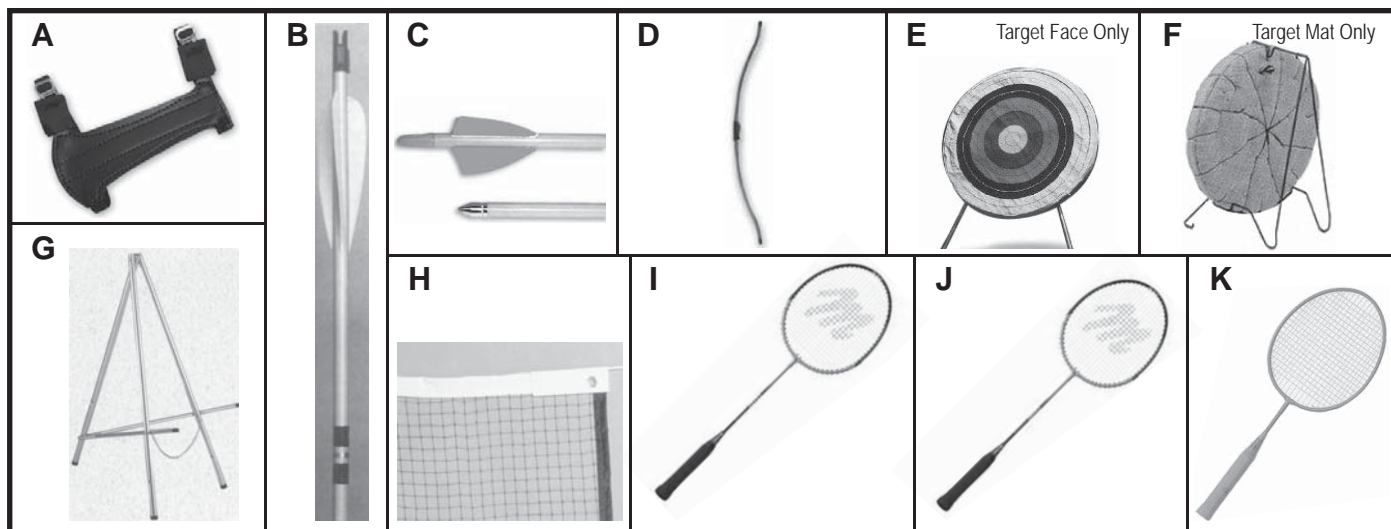

ARCHERY / ARM GUARD

A) Arm Guard

Leather body, 7" long, 2 adjustable elastic straps with hook and loop fasteners. Qualifying Standard: Cannon.

KCDA No.	U/M	1-35	36+
60281	Ea	3.22	3.17

ARCHERY / ARROWS

B) Deluxe Cedar Arrows

5/16" cedar shafts with target points, snap nocks and 3" fletching. Qualifying Standard: BSN.

KCDA No.	Length	U/M	1-11	12+
60081	28"	72/Pkg	197.99	190.20

C) Standard Cedar Arrows

5/16" cedar shafts with target points, 2-1/2" fletching and snap nocks. Qualifying Standard: BSN.

KCDA No.	Length	U/M	1-29	30+
60102	26"	Doz	36.27	35.41
60103	28"	Doz	38.10	37.20

ARCHERY / BOW STRING

Bow String

Double loop string with mono center serving. Braided hollow diamond line with a loop on each end. Qualifying Standard: BSN.

60311 use with bow KCDA No. 60009

60312 use with bow KCDA No. 60003

60313 use with bow KCDA No. 60008

KCDA No.	Length	U/M	1-23	24+
60313	40"	Ea	5.31	5.18
60311	46"	Ea	5.31	5.18
60312	56"	Ea	5.31	5.18

ARCHERY / BOWS

D) Bows, Recurved Fiberglass

Practically unbreakable, shoots right or left handed, molded plastic handle, braided dacron bow strings. Qualifying Standard: BSN.

60008 use string KCDA No. 60313

60009 use string KCDA No. 60311

60003 use string KCDA No. 60312

KCDA No.	Desc	U/M	1-23	24+
60008	15 lb Draw, 44" Long	Ea	17.48	17.20
60009	20 lb Draw, 51" Long	Ea	21.20	20.86
60003	30 lb Draw, 60" Long	Ea	36.25	35.67

ARCHERY / TARGET FACE

E) Target Face

Poly spun fibers bonded under heat and pressure, skirted, round, four-color. Qualifying Standard: BSN.

KCDA No.	Size	U/M	1-23	24+
60252	36"	Ea	14.25	13.91
60254	48"	Ea	20.73	20.24

ARCHERY / TARGET MAT

F) Target Mat

Fiber flex straw mats, 3 times the life span of regular straw. Qualifying Standard: BSN.

KCDA No.	Size	U/M	1-11	12+
60152	36" face	Ea	118.75	114.00
60153	48" face	Ea	181.25	174.00

ARCHERY / TARGET STAND

G) Target Stand

Deluxe model with metal tripod. Adjustable for 36" and 48" targets. Rubber tips on legs permit indoor use. Qualifying Standard: BSN.

KCDA No.	U/M	1-11	12+
60200	Ea	25.06	24.47

BADMINTON / NET

H) Badminton Net

21' long, 3/4" mesh, nylon cord through top binding, synthetic binding top and bottom, black. Qualifying Standard: BSN, PROSTAR.

KCDA No.	U/M	1-17	18+
60401	Ea	8.26	8.06

BADMINTON / RACKETS

I) Badminton Racket

Steel frame and shaft, twisted nylon string, glued leather grip. Qualifying Standard: MacGregor.

KCDA No.	U/M	1-5	6+
60485	Ea	4.84	4.72

J) Badminton Racket

Wide body aluminum head 20 gauge braided nylon string for durability, ribbed tournament grip. Qualifying Standard: BSN.

KCDA No.	U/M	1-23	24+
60500	Ea	10.67	10.42

K) Mini Badminton Racket

20" length for elementary use. Qualifying Standard: Champion.

KCDA No.	U/M	1-23	24+
61232	Ea	4.19	4.13

2011 KCDA CATALOG

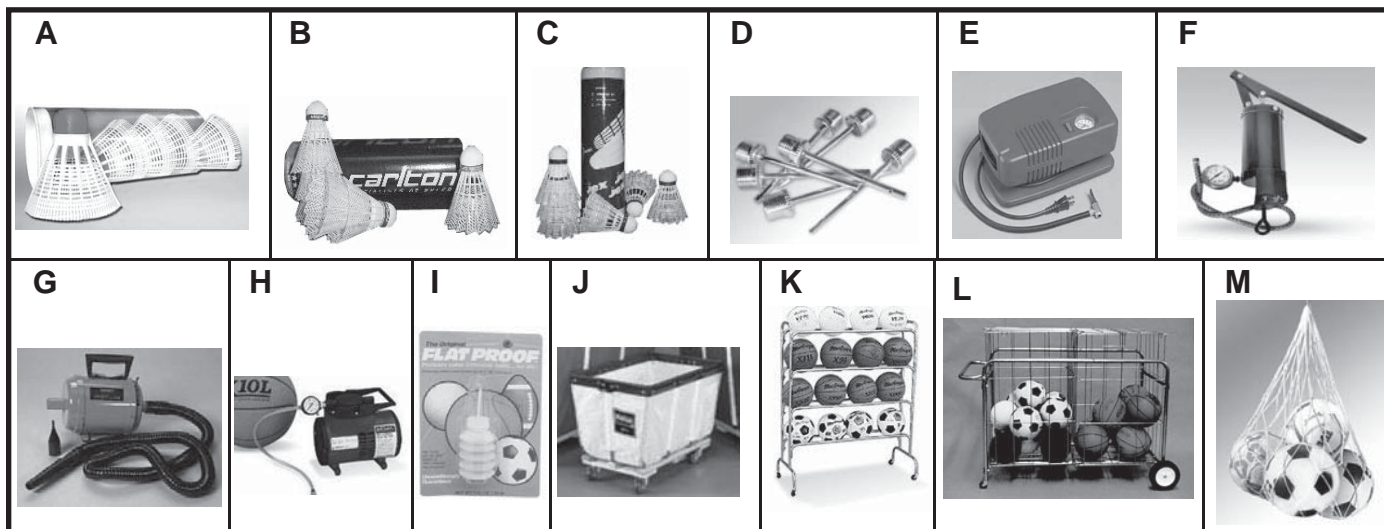

BADMINTON / SHUTTLECOCKS

A) Badminton Shuttlecocks

Nylon skirt, cork tip, for indoors, medium speed. Qualifying Standard: BSN.

KCDA No.	U/M	1-95	96+
60543	6/Can	1.14	1.12

B) Badminton Shuttlecocks

Nylon skirt, cork tip, medium speed, USBA approved. Qualifying Standard: Carlton.

KCDA No.	U/M	1-47	48+
60526	6/Can	8.09	7.96

C) Badminton Shuttlecocks

Nylon, Indoor. Qualifying Standard: Pro Star.

KCDA No.	U/M	1-95	96+
60530	6/Can	4.46	4.39

BALL / INFLATING NEEDLES

D) Inflating Needles

For rubber and leather balls. Qualifying Standard: CSI.

KCDA No.	U/M	1-35	36+
64233	Doz	1.39	1.37

BALL / PUMPS

E) Ball Pump, Electric

Heavy duty, 150 PSI, 2 year warranty. Qualifying Standard: Athletic Spec.

KCDA No.	U/M	1-5	6+
62475	Ea	49.96	49.14

F) Ball Pump, Manual

Table top with gauge and hose. Qualifying Standard: Athletic Spec.

KCDA No.	U/M	1-11	12+
62485	Ea	30.20	29.01

G) Cage Ball Pump

For easy inflating and deflating cage balls. 1.17 peak horsepower high-volume air power for rapid inflation. 6-ft. flexible hose with CFM power control and two tapered inflator adapters (7/8" O.D.; 3/16" O.D.). 12-ft., 18-gauge 3-conductor grounded power supply cord. All-steel construction with weather-resistant baked enamel finish. For use with cage ball KCDA No. 61103. Qualifying Standard: Metro.

KCDA No.	U/M	1-5	6+
62486		167.45	164.70

H) National Ball Pump, Electric

Heavy duty industrial quality, special air control valve, 30 pound pressure gauge, 8 foot electric cord, three prong plug, 18" clear vinyl hose, needle included. National 3190, No Substitute.

KCDA No.	U/M	1-5	6+
62470	Ea	329.40	324.00

BALL / REPAIR

I) Flat Proof Repair Unit

Permanently repairs small punctures in reinforced carcass balls. 1 ounce plastic squeeze bottle, repairs two balls. Qualifying Standard: CSI.

KCDA No.	U/M	1-35	36+
64231	Bl	1.26	1.24

BALL / TRANSPORTATION

J) Ball Basket Truck

Heavy duty construction, heavy weight white canvas, hardwood base, large work order pocket. 4 swivel casters. Qualifying Standard: Royal.

KCDA No.	U/M	1-11	12+
60793	Ea	225.70	222.00

K) Ball Cart

Heavy duty, chromed steel tubing, non-marring hard rubber casters, wide no-topple base. Qualifying Standard: BSN.

KCDA No.	Description	U/M	1-3	4+
64329	4-Tier, Holds 16 Balls	Ea	45.50	44.74

L) Ball Locker

Lockable ball carrier. Made to use outside with two 8" fixed wheels and two free wheeling rubber casters. Each basket is 21"L x 21"W x 32"H and holds 12 basketballs. Overall size is 46"L x 24"W x 40"H. Frame is 1" galvanized steel tube. TC Sports MTC007, No Substitute.

KCDA No.	U/M	1-3	4+
64317	Ea	267.05	262.63

M) Mesh Ball Bag

Nylon cord, 4" mesh, 40" long with braided nylon cord drawstring, holds 8 to 12 large balls. Qualifying Standard: CSI.

KCDA No.	U/M	1-23	24+
60791	Ea	2.35	2.31

2011 KCDA CATALOG

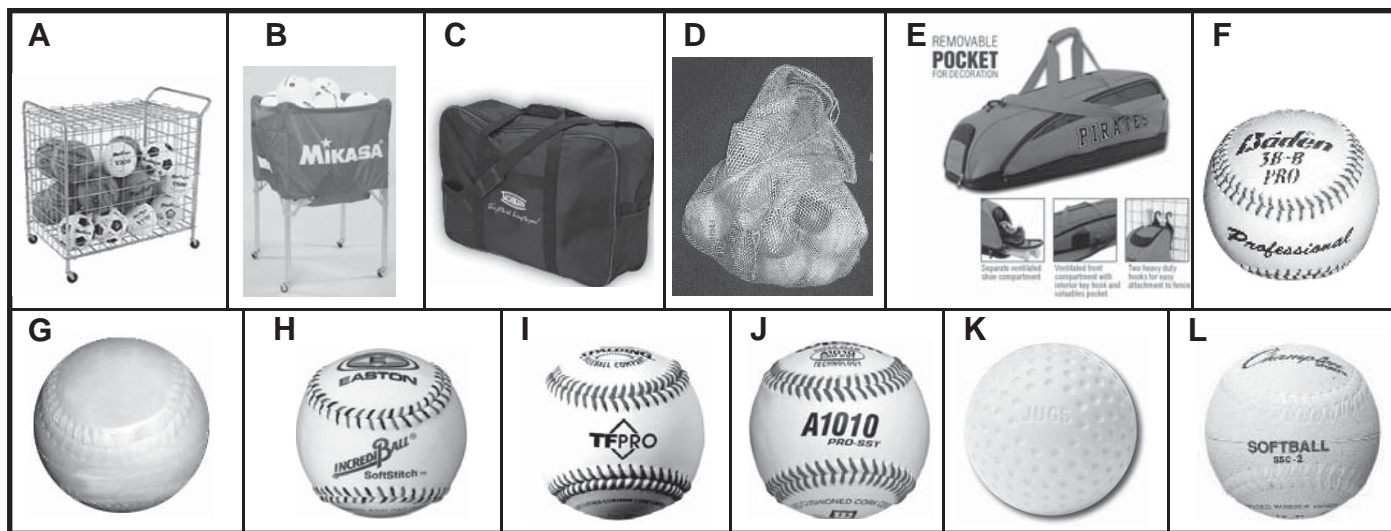

A) Portable Ball Locker

Made to use inside. 3/4" steel tubing frame, heavy gauge steel wire mesh, lockable hinged cover, 4 casters, Approximately. 24" wide x 42" long x 36" high. Qualifying Standard: BSN.

KCDA No.	U/M	1-3	4+
64324	Ea	133.08	130.88

B) Travel Ball Cart

Nylon fabric with aluminum frame. 25" wide x 25" deep x 39" high, caster wheels. Holds approximately 20 basketballs or 30 volleyballs/soccer balls. Disassembles for easy travel. Blue. Qualifying Standard: Mikasa.

KCDA No.	U/M	1-3	4+
64323	Ea	119.25	117.31

C) Volleyball Bag

Holds 6 balls, adjustable shoulder strap and velcro handles, black, 24"x8"x15.75", two mesh end pockets. Qualifying Standard: Tachikara.

KCDA No.	U/M	1-11	12+
64053	Ea	21.39	21.04

BASEBALL/SOFTBALL / BAGS

D) Baseball/Softball/Laundry Bag

18" x 24", 100% nylon mesh net, white, holds 20 to 25 small balls. Qualifying Standard: BSN.

KCDA No.	U/M	1-23	24+
60621	Ea	2.45	2.41

E) Bat Bags

Classic locker bag, shoulder strap and fence clip, holds shoes and 3 bats. 36" long x 7" wide x 15" high, 3 zipper compartment. Qualifying Standard: ProTeam.

KCDA No.	Color	U/M	1-11	12+
60609	Scarlet	Ea	22.25	21.89

BASEBALL/SOFTBALL / BALLS / BASEBALLS

F) Baden Leather Covered Baseball

Official, major league approved, cork center, 1st quality wool yarn, professional grade alum tanned leather cover, WIAA adopted ball. Baden 3B-PPRO Perfection, No Substitute.

KCDA No.	U/M	1-5	6+
60652	Doz	61.49	60.48

G) Practice Baseball

Rubber covered, nylon windings, official size. Qualifying Standard: Richardson.

KCDA No.	U/M	1-5	6+
60681	Doz	22.46	21.92

H) Easton Incrediball

9". Stingless, safe league ball for younger players. Use indoors or outdoors. Durable washable, lockstitched double-knit cover. Easton 122305S, No Substitute.

KCDA No.	U/M	1-11	12+
60645	12/Box	34.41	33.84

I) Spalding Horse Hide Covered Baseball

Official major league approved cork center, 1st quality wool yarn, double needle stitched with waxed thread. Spalding 41-180, No Substitute.

KCDA No.	U/M	1-5	6+
60654	Doz	57.24	56.30

J) Wilson Horse Hide Covered Baseball

Official major league approved cork center, 1st quality wool yarn, double needle stitched with waxed thread. Wilson A1010BML-RS, No Substitute.

KCDA No.	U/M	1-5	6+
60653	Doz	62.53	61.50

BASEBALL/SOFTBALL / BALLS / PITCHING MACHINE

K) Jugs Pitching Machine Baseball

Dimpled yellow. Jugs DIM, No Substitute.

KCDA No.	U/M	1-5	6+
60644	Ea	2.09	2.04

Jugs Pitching Machine Softball

Yellow. Jugs, No Substitute.

KCDA No.	Mfg. No.	Size	U/M	1-5	6+
63201	JUGS	12"	Ea	2.94	2.87

BASEBALL/SOFTBALL / BALLS / SOFTBALLS

L) 12" Softball

White, soft rubber cover, cork/rubber center, nylon winding. Qualifying Standard: Champro.

KCDA No.	U/M	1-35	36+
63233	Ea	2.79	2.72

2011 KCDA CATALOG

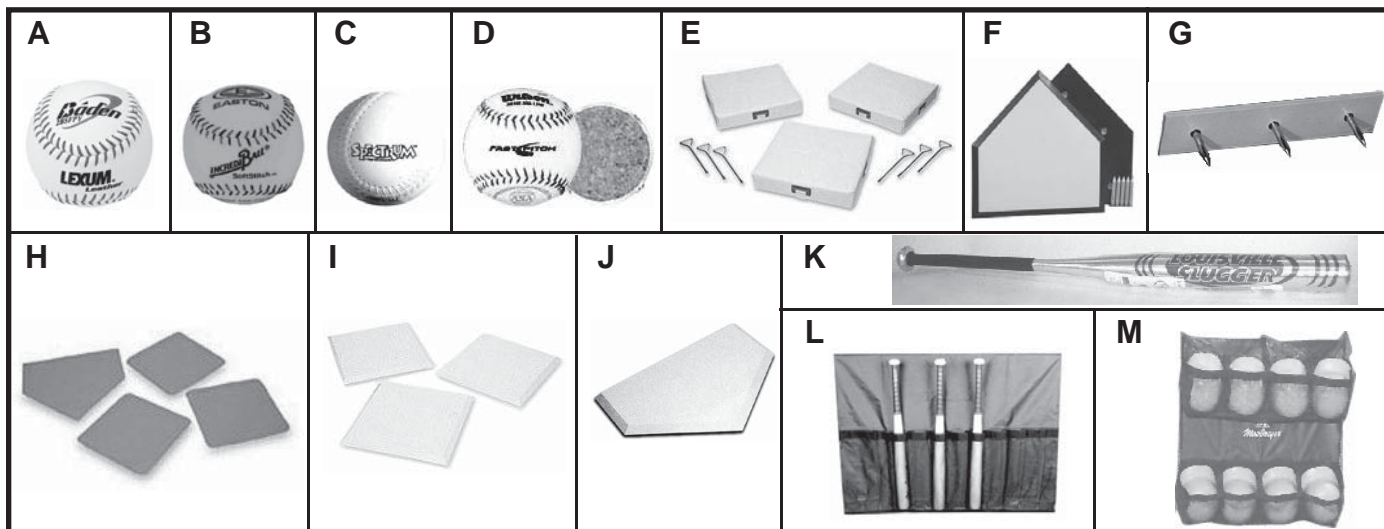

A) Baden 12" Fast Pitch Softball

Lexum fast pitch softball, 12" poly core, optic yellow with red stitching, raised seam, .47 COR. NFHS approved and WIAA adopted ball. Baden 2BSFPY, No Substitute.

KCDA No.	U/M	1-5	6+
60665	Doz	62.07	60.55

Diamond 12" Fast Pitch Softball

Can be used for practice balls, white, ASA approved. Diamond 12WSC47375, No Substitute.

KCDA No.	U/M	1-35	36+
63223	Ea	3.96	3.87

B) Easton 12" Incredibal

Softstitch, neon yellow. Stingless, safe league ball for younger players and injury-free training aid for older players. Use indoors or outdoors. Durable washable, lockstitched double-knit cover. Easton, No Substitute.

KCDA No.	U/M	1-11	12+
63232	Ea	3.80	3.70

C) Spectrum 12" Rubber Softballs

Official league size, rubber cover, with nylon winding. Spectrum, No Substitute.

KCDA No.	Description	Mfg. No.	U/M	1-35	36+
63241	Soft Sponge Center	W7123	Ea	2.03	2.00
63221	Solid Cork Center	W7122	Ea	3.68	3.63

D) Wilson 12" Practice Softballs

Yellow. Wilson, No Substitute.

KCDA No.	Description	Mfg. No.	U/M	1-35	36+
63213	Cork Center	9106BWHS	Ea	4.67	4.60

BASEBALL/SOFTBALL / BASES/PLATES

E) Baseball Bases

Heavy duty vinyl, water and weather resistant poly foam inner core for maximum shape retention and soft landing cushion, three bases, with 6 spikes. Qualifying Standard: BSN.

KCDA No.	U/M	1-3	4+
60700	9/Set	32.36	31.60

F) Baseball/Softball Home Plate

Official for baseball, softball and little league, white rubber with black beveled edges, five removable spikes. Qualifying Standard: BSN.

KCDA No.	U/M	1-5	6+
60710	Ea	14.60	14.26

G) Baseball/Softball Pitching Plate

Official for baseball and softball, white rubber, three removable spikes. Qualifying Standard: BSN.

KCDA No.	U/M	1-11	12+
60720	Ea	9.37	9.15

H) Softball Base Set

Complete set with home plate, indoor and outdoor, throw down style, orange rubber. Qualifying Standard: BSN.

KCDA No.	U/M	1-11	12+
63290	4/Set	6.44	6.29

I) Softball Bases

Rubber with non-skid bottom for indoor and outdoor use, no spikes, three bases, no home plate. Qualifying Standard: Voit, BSN.

KCDA No.	U/M	1-7	8+
63270	3/Set	18.35	18.06

J) Softball Home Plate

Rubber, non-skid bottom. Qualifying Standard: Prostar.

KCDA No.	U/M	1-23	24+
63280	Ea	8.74	8.53

BASEBALL/SOFTBALL / BATS / SOFTBALL

K) Louisville Aluminum Softball Bats

Completely molded bat, 2-1/4" barrel diameter, handle and knob. Louisville, No Substitute.

KCDA No.	Description	Mfg. No.	U/M	1-11	12+
63352	32", 25 oz	EP303	Ea	19.68	19.22
63354	34", 27 oz	EP303	Ea	19.68	19.22

BASEBALL/SOFTBALL / CADDIES

L) Bat Caddie

Heavy duty nylon reinforced black vinyl. Holds up to 8 bats. Mesh pockets for viewing. Rolls up for transport and storage. Qualifying Standard: BSN.

KCDA No.	U/M	1-11	12+
60615	Ea	14.94	14.70

M) Helmet Caddie

Heavy duty nylon reinforced black vinyl. Holds up to 8 helmets. Mesh pockets for viewing. Rolls up for transport and storage. Qualifying Standard: BSN.

KCDA No.	U/M	1-11	12+
60616	Ea	16.19	15.92

2011 KCDA CATALOG

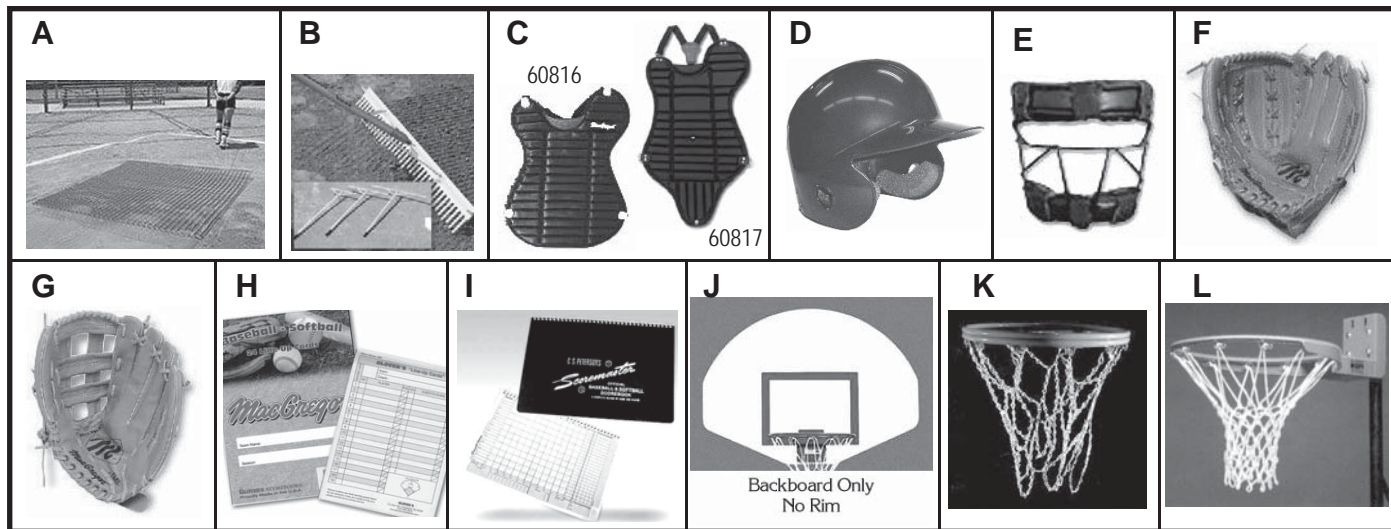

BASEBALL/SOFTBALL / FIELD MAINTENANCE

A) Drag Mat

Steel drag mat include drag bar and rope. Qualifying Standard: BSN.

KCDA No.	Size	U/M	1-11	12+
63360	3	Ea	146.40	144.00

B) Rake

Aluminum maintenance rake, durable. Lightweight with big teeth on one side and leveler on the other. Qualifying Standard: BSN.

KCDA No.	Size	U/M	1-11	12+
63391	36"	Ea	46.95	46.18

BASEBALL/SOFTBALL / PROTECTIVE GEAR / CHEST PROTECTORS

C) Chest Protectors

Black. Qualifying Standard: BSN.

KCDA No.	Type	U/M	1-11	12+
60816	Men, Adult	Ea	16.38	16.13
60817	Youth, Little League	Ea	17.78	17.50

BASEBALL/SOFTBALL / PROTECTIVE GEAR / HELMETS

D) Schutt Batting Helmets

Navy, air padded. Schutt, No Substitute.

KCDA No.	Size	Mfg. No.	U/M	1-23	24+
60795	Small	2794	Ea	17.59	17.31
60796	Medium	2794	Ea	17.59	17.31

BASEBALL/SOFTBALL / PROTECTIVE GEAR / MASKS

E) Softball Catchers Mask

Vinyl hook and loop fasteners pads with high impact protective black plastisol wire frame. Includes built in cheek bar. Qualifying Standard: BSN.

KCDA No.	U/M	1-11	12+
63055	Ea	14.73	14.38

BASEBALL/SOFTBALL / PROTECTIVE GEAR / MITTS/GLOVES

F) BSN Baseman's Mitts

Cowhide leather, double-lock web, extended palm design, adjustable thumb and finger loops, fleece-lined wrist strap. BSN, No Substitute.

Left-handed is worn on the right hand.

Right-handed is worn on the left hand.

KCDA No.	Description	Mfg. No.	U/M	1-23	24+
63157	Left-Handed	BBFBPROR	Ea	37.64	36.75
63155	Right-Handed	BBFBROX	Ea	37.64	36.75

G) BSN Fielder's Mitts

Adjustable wrist, cool, comfortable nylon back, light weight, select hand-crafted leather. BSN, No Substitute.

Left-handed is worn on the right hand.

Right-handed is worn on the left hand.

KCDA No.	Description	Mfg. No.	U/M	1-23	24+
63162	Left-Handed	BBMESHXX	Ea	14.99	14.63
63160	Right-Handed	BBNESHXX	Ea	14.99	14.63

BASEBALL/SOFTBALL / SCOREKEEPING/LINE-UP CARDS

H) Lineup Cards

15 position slots, 4 part form with 3 carbonless copies, 5-1/2"x8-1/2" firm backing. Qualifying Standard: BSN.

KCDA No.	U/M	1-11	12+
62903	24/Pkg	4.51	4.44

I) Scoremaster Baseball/Softball Scorebook

So easy, anyone can be an expert scorekeeper. Keep a simplified, detailed history of each game. Wire bound, 25 game pages, 11 players. Peterson Scoremaster MSPTRBOK, No Substitute.

KCDA No.	U/M	1-23	24+
62901	Ea	3.77	3.71

BASKETBALL / BACKBOARDS / NETS / RIMS

J) Basketball Backboard

Official size 39"x54" fan-shaped steel backboard, universal front mount, 5"x5" hole pattern, standard 20"x30" fan-type backboard mounting holes, 12 gauge skin, white graffiti-resistant powder coated finish, 10 year limited guarantee. Weight: 96 lbs. Backboard only does not come with rim. Qualifying Standard: Bison Dura Steel.

KCDA No.	U/M	1-11	12+
60971	Ea	567.00	557.93

Basketball Hoop Net

Nylon, white, no-whip. Qualifying Standard: Pro star.

KCDA No.	U/M	1-23	24+
60980	Ea	2.06	2.01

K) Basketball Hoop Net, Outdoor

Steel chain link. Qualifying Standard: CSI.

KCDA No.	U/M	1-11	12+
60991	Ea	6.49	6.34

L) Bison Basketball Hoop/Rim

Rear mount, official orange. Bison BA21, No Substitute.

KCDA No.	U/M	1-3	4+
60964	Pair	166.50	163.84

2011 KCDA CATALOG

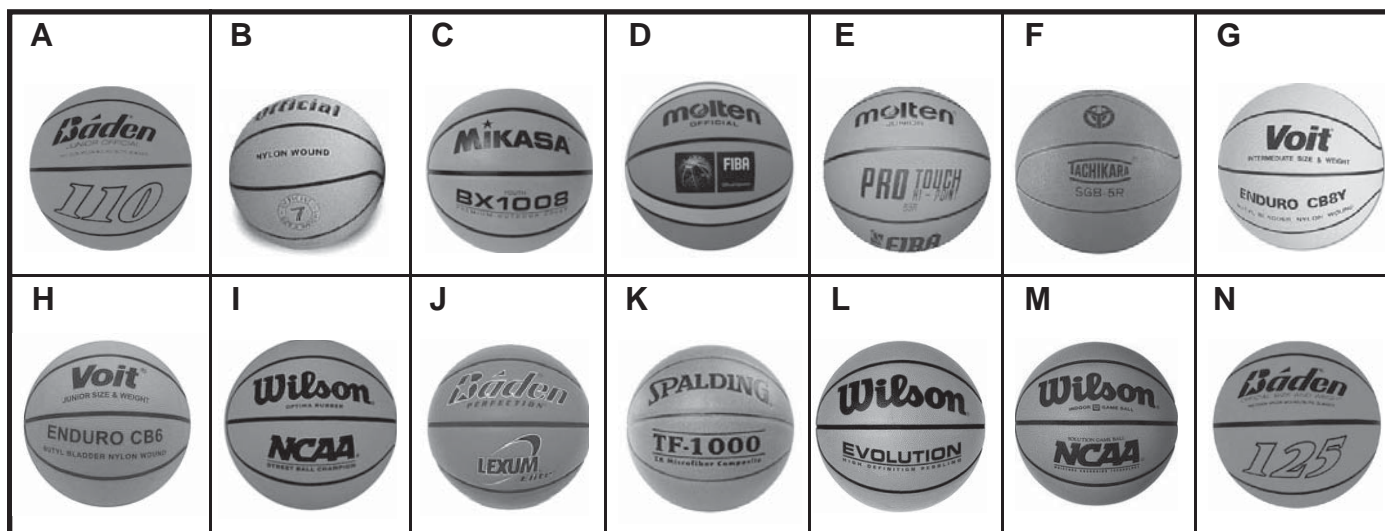

BASKETBALL / BALLS / JUNIORS

A) Baden Junior Rubber Covered Basketball

Official, 27-1/4" to 27-3/4" circumference. Baden B110, No Substitute.

KCDA No.	U/M	1-11	12+
60919	Ea	7.15	7.03

B) MacGregor Junior Optic Yellow Basketball

Rubber basketball with nylon winding, high visibility optic yellow. MacGregor X425, No Substitute.

KCDA No.	U/M	1-11	12+
60928	Ea	4.50	4.43

C) Mikasa Junior Rubber Covered Basketball

Official, 27-1/4" to 27-3/4" circumference. Mikasa BX1008, No Substitute.

KCDA No.	U/M	1-11	12+
60918	Ea	5.84	5.75

D) Molten Junior Rubber Covered Basketball

Official, 27-1/4" to 27-3/4" circumference. Molten BGR5, No Substitute.

KCDA No.	U/M	1-11	12+
60916	Ea	6.71	6.60

E) Molten Junior Rubber Covered Basketball

Official, 27-1/4" to 27-3/4" circumference. Molten B5R, No Substitute.

KCDA No.	U/M	1-11	12+
60827	Ea	5.21	5.12

F) Tachikara Junior Rubber Covered Basketball

28" circumference, intermediate, orange. Tachikara SGB5R, No Substitute.

KCDA No.	U/M	1-23	24+
60895	Ea	4.67	4.60

G) Voit Junior Rubber Covered Basketball

28" circumference, intermediate, orange. Voit CB8, No Substitute.

KCDA No.	U/M	1-23	24+
60927	Ea	3.72	3.66

H) Voit Junior Rubber Covered Basketball

Official, 27-1/4" to 27-3/4" circumference. Voit CB6, No Substitute.

KCDA No.	U/M	1-11	12+
60920	Ea	3.61	3.55

I) Wilson Junior Rubber Covered Basketball

Official, 27-1/4" to 27-3/4" circumference. Wilson WTB0762XDEF, No Substitute.

KCDA No.	U/M	1-11	12+
60915	Ea	6.21	6.11

BASKETBALL / BALLS / MEN'S / COMPOSITE

J) Baden Men's Basketball

Ultra microfiber cover, cushion control technology, exclusive symmetrical design and hidden valve system which eliminates bad bounces. SureGrip provides a tackified pebble surface. Precision nylon-wound, 100% 2-ply butyl bladder with wide channel. Official size and weight and approved by the NFHS and FIBA. This is the WIAA Adopted Ball. Baden BX7E, No Substitute.

KCDA No.	U/M	1-11	12+
60882	Ea	45.08	44.34

K) Spalding Men's Basketball

Official size and weight, wide seams, cushion control composite cover, NFHS Approved. Spalding TF1000, No Substitute.

KCDA No.	U/M	1-11	12+
60851	Ea	36.94	36.63

L) Wilson Men's Basketball

Official size and weight, wide seams, cushion control composite cover, NFHS Approved. Wilson B0516, No Substitute.

KCDA No.	U/M	1-11	12+
60880	Ea	41.60	40.92

M) Wilson Men's Composition Basketball

Wide channel composite leather game ball. NFHS approved. Indoor only for males over 12. 3 year warranty. Wilson B0700, No Substitute.

KCDA No.	U/M	1-11	12+
60898	Ea	52.09	51.24

BASKETBALL / BALLS / MEN'S / RUBBER

N) Baden Men's Durable Rubber Basketball

Official size and weight, practice ball, excellent wearing qualities, indoor or outdoor, orange. Baden B125, No Substitute.

KCDA No.	U/M	1-23	24+
60891	Ea	7.35	7.17

Please check our website at www.kcda.org - Click on the gold button and login to Supply Link button for the most current listing of products and pricing. Pricing in this catalog are as of the printing date and are subject to change without notice.

2011 KCDA CATALOG

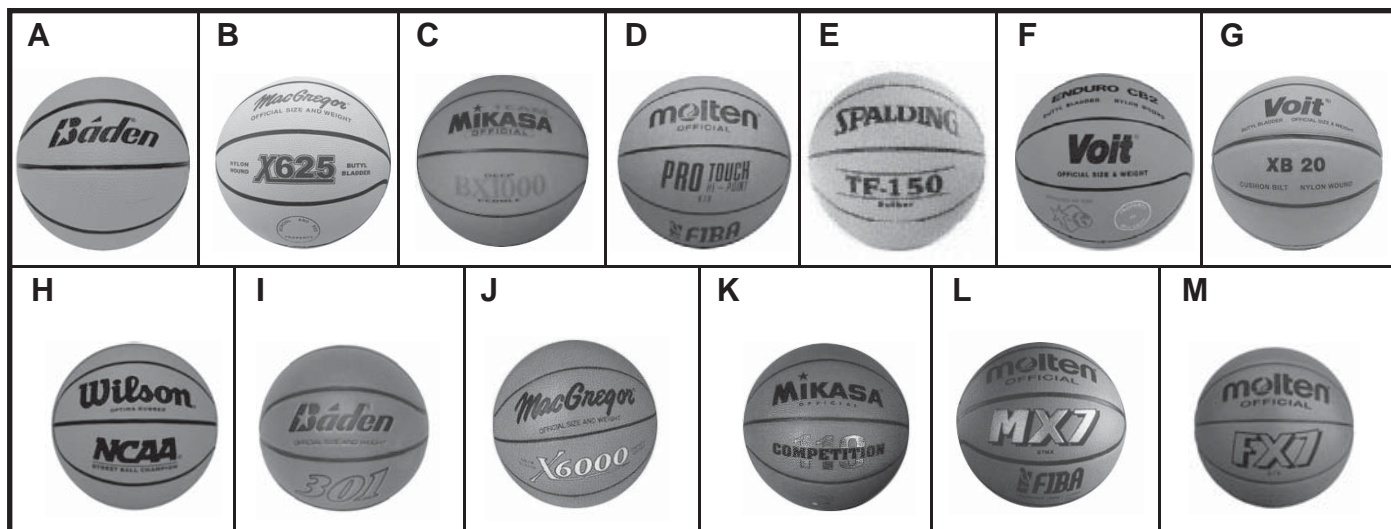

A) Baden Men's Rubber Basketball

Official game ball, deep pebble grain finish and channel seams, rubber replaceable self sealing valve, orange color. Baden BX260, No Substitute.

KCDA No.	U/M	1-5	6+
60875	Ea	11.14	10.87

B) MacGregor Men's Optic Yellow Rubber Basketball

With nylon winding, high visibility optic yellow. MacGregor X625, No Substitute.

KCDA No.	U/M	1-11	12+
60930	Ea	4.95	4.87

C) Mikasa Men's Durable Rubber Basketball

Official size and weight, practice ball, excellent wearing qualities, indoor or outdoor, orange. Mikasa BX1000, No Substitute.

KCDA No.	U/M	1-23	24+
60892	Ea	6.09	5.94

D) Molten Men's Rubber Basketball

Official game ball, deep pebble grain finish and channel seams, rubber replaceable self sealing valve, orange color. Molten B7R, No Substitute.

KCDA No.	U/M	1-5	6+
60829	Ea	6.04	5.94

E) Spalding Men's Rubber Basketball

Official game ball, deep pebble grain finish and channel seams, rubber replaceable self sealing valve, orange color. Spalding TF150, No Substitute.

KCDA No.	U/M	1-5	6+
60873	Ea	5.49	5.36

F) Voit Men's Rubber Basketball

Official size and weight, practice ball, excellent wearing qualities, indoor or outdoor, orange. Voit CB2, No Substitute.

KCDA No.	U/M	1-23	24+
60896	Ea	3.72	3.66

G) Voit Men's Rubber Basketball

Official game ball, deep pebble grain finish and channel seams, rubber replaceable self sealing valve, orange color. Voit XB20, No Substitute.

KCDA No.	U/M	1-5	6+
60876	Ea	6.93	6.82

H) Wilson Men's Rubber Basketball

NCAA street ball champion, official size. Optimal rubber cover for consistent performance for the recreational player. Super wide channels for increased grip and control. Wilson WTB0760, No Substitute.

KCDA No.	U/M	1-23	24+
60897	Ea	6.36	6.21

BASKETBALL / BALLS / MEN'S / SYNTHETIC

I) Baden Men's Synthetic Leather Basketball

Scuff-proof and waterproof, wear resistant, feels and performs like leather, but more durable for play on any court. Wide seams. Baden B301, No Substitute.

KCDA No.	U/M	1-11	12+
60885	Ea	18.67	18.36

J) MacGregor Men's Synthetic Leather Basketball

Scuff-proof and waterproof, wear resistant, feels and performs like leather, but more durable for play on any court. MacGregor X6000, No Substitute.

KCDA No.	U/M	1-11	12+
60867	Ea	14.91	14.66

K) Mikasa Men's Synthetic Leather Basketball

Scuff-proof and waterproof, wear resistant, feels and performs like leather, but more durable for play on any court. Mikasa BWL110N, No Substitute.

KCDA No.	U/M	1-11	12+
60862	Ea	17.56	17.27

L) Molten Men's Synthetic Basketball

Synthetic cover office size, wide seam, indoor/outdoor. Molten B7MXW, No Substitute.

KCDA No.	U/M	1-11	12+
60900	Ea	18.91	18.60

M) Molten Men's Synthetic Leather Basketballs

Scuff-proof and waterproof, wear resistant, feels and performs like leather, but more durable for play on any court. Molten, No Substitute.

KCDA No.	Description	Mfg. No.	U/M	1-11	12+
60833	Wide Seams	B7XW	Ea	28.67	28.20

2011 KCDA CATALOG

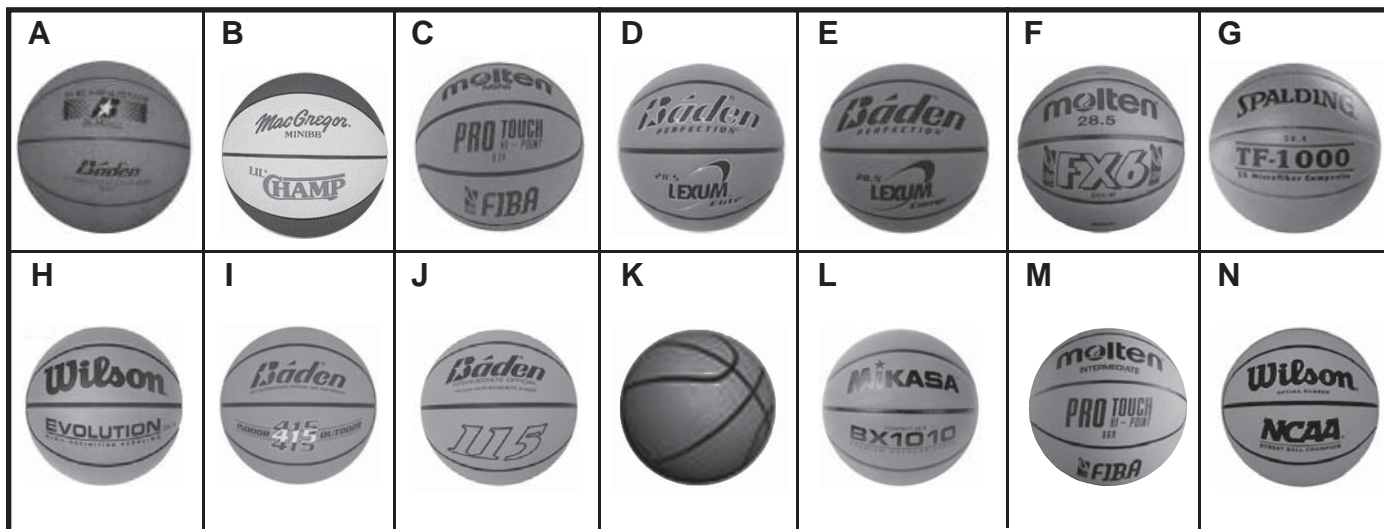

BASKETBALL / BALLS / MINI RUBBER

A) Baden Mini Rubber Basketball

For K-3rd grades. Baden B50, No Substitute.

KCDA No.	U/M	1-11	12+
60870	Ea	5.44	5.22

B) MacGregor Lil'champ Mini Rubber Basketball

For K-3rd grades. MacGregor Lil'champ, MCMINIBB, No Substitute.

KCDA No.	U/M	1-11	12+
60877	Ea	5.20	5.11

C) Molten Mini Rubber Basketball

For K-3rd grades. Molten B3R, No Substitute.

KCDA No.	Description	U/M	1-11	12+
60826	Molten	Ea	5.21	5.12

BASKETBALL / BALLS / WOMEN'S / COMPOSITE

D) Baden Women's Composite Basketball

The Perfection Elite indoor basketball, ultra microfiber cover with cushion control technology. Exclusive symmetrical design and hidden valve system which eliminates bad bounces. SureGrip provides a tackified pebble surface, precision nylon-wound 100% 2-ply butyl bladder with wide channel. Official 28.5 size and weight, Approved by the NFHS. This is the WIAA Adopted Ball. Baden BX6E, No Substitute.

KCDA No.	U/M	1-11	12+
60883	Ea	45.08	44.34

E) Baden Women's Composite Basketball

Official size 28.5" and weight, wide seams, cushion control composite cover. NFHS approved. Baden BX446, No Substitute.

KCDA No.	Description	U/M	1-11	12+
60822	Baden	Ea	36.56	35.96

F) Molten Women's Composite Basketball

Composite wide seam basketball, intermediate size, 28.5", super tacky material, wide seam, 2-year guarantee, NFHS approved. Molten B6X-W, No Substitute.

KCDA No.	U/M	1-11	12+
60902	Ea	28.67	28.20

Please check our website at www.kcda.org - Click on the gold button and login to Supply Link for the most current listing of products and pricing. Pricing in this catalog are as of the printing date and are subject to change without notice.

G) Spalding Women's Composite Basketball

Official size 28.5" and weight, wide seams, cushion control composite cover. NFHS approved. Spalding TF1000. No Substitute.

KCDA No.	U/M	1-11	12+
60852	Ea	36.94	36.63

H) Wilson Women's Composite Basketball

Official size 28.5" and weight, wide seams, cushion control composite cover. NFHS approved. Wilson B0586, No Substitute.

KCDA No.	U/M	1-11	12+
60881	Ea	41.60	40.92

BASKETBALL / BALLS / WOMEN'S / RUBBER

I) Baden Women's Rubber Basketball

Official size, 28.5", rubber composition, 100% nylon wound, butyl bladder, replaceable valve, Baden BR415, No Substitute.

KCDA No.	U/M	1-11	12+
64316	Ea	6.19	6.04

J) Baden Women's Rubber Basketball

Orange, 28" circumference, intermediate. Baden B115, No Substitute.

KCDA No.	U/M	1-23	24+
60921	Ea	7.35	7.17

K) MacGregor Women's Rubber Basketball

Yellow, high visibility optic with nylon winding. MacGregor X525, No Substitute.

KCDA No.	U/M	1-11	12+
60929	Ea	4.57	4.50

L) Mikasa Women's Rubber Basketball

28-1/2" to 29", two-ply 100% butyl bladder. Mikasa BX1010, No Substitute.

KCDA No.	U/M	1-11	12+
60866	Ea	5.86	5.76

M) Molten Women's Rubber Basketball

28-1/2" to 29", two-ply 100% butyl bladder. Molten B6R. No Substitute.

KCDA No.	U/M	1-11	12+
60828	Ea	6.04	5.94

N) Wilson Women's Rubber Basketball

28-1/2" to 29", two-ply 100% butyl bladder. Wilson WTB761XDEF, No Substitute.

KCDA No.	U/M	1-11	12+
60932	Ea	6.21	6.11

2011 KCDA CATALOG

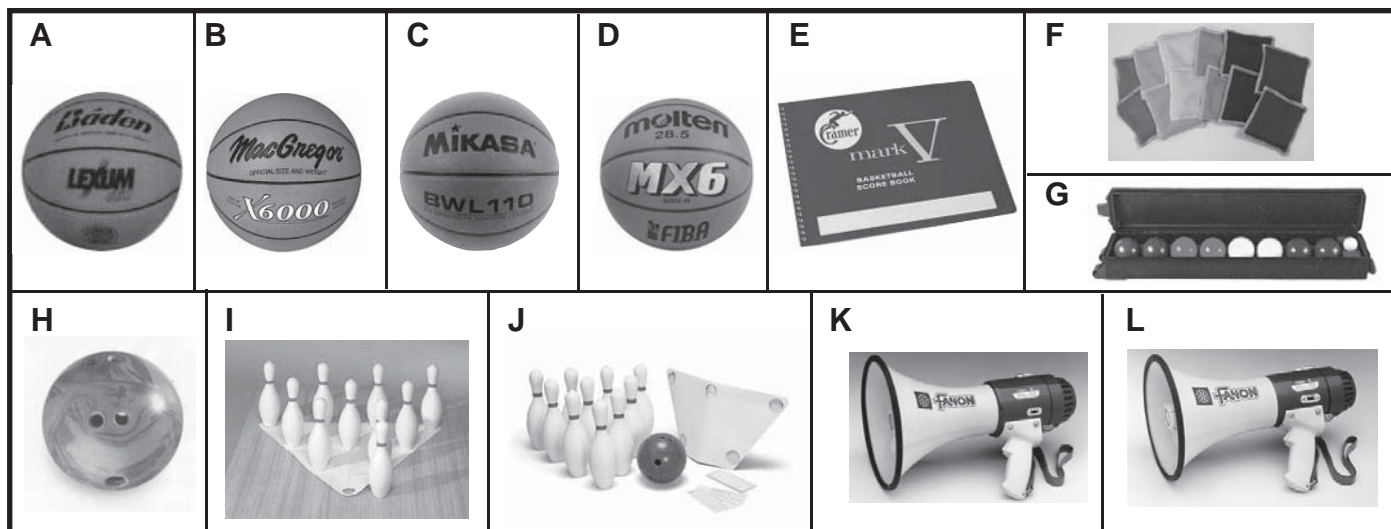

BASKETBALL / BALLS / WOMEN'S / SYNTHETIC

A) Baden Women's Synthetic Basketball

Synthetic leather cover, scuff-proof, water proof and wear-resistant, feels and performs like leather, but more durable. Baden B285W, No Substitute.

KCDA No.	U/M	1-11	12+
60890	Ea	18.67	18.36

B) MacGregor Women's Synthetic Basketball

Synthetic leather cover, scuff-proof, water proof and wear-resistant, feels and performs like leather, but more durable. MacGregor X6285, No Substitute.

KCDA No.	U/M	1-11	12+
60871	Ea	15.68	15.42

C) Mikasa Women's Synthetic Basketball

Synthetic leather cover, scuff-proof, water proof and wear-resistant, feels and performs like leather, but more durable. Mikasa BWLC110, No Substitute.

KCDA No.	U/M	1-11	12+
60864	Ea	17.56	17.27

D) Molten Women's Synthetic Basketball

Size 6, indoor/outdoor, synthetic cover has a soft and tacky surface. Pattern nylon wound, butyl bladder, intermediate size and weight. Molten B6MX, No Substitute.

KCDA No.	U/M	1-11	12+
60901	Ea	18.91	18.60

BASKETBALL / SCOREBOOK

E) Cramer Basketball Scorebook

For boys and girls. Cramer Mark V. No Substitute.

KCDA No.	U/M	1-23	24+
62902	Ea	5.10	5.02

BEAN BAGS

F) Bean Bags

4"x4", 2 ounce of pea gravel. Colors include: Red, Orange, Yellow, Purple and Navy. Qualifying Standard: Champion.

KCDA No.	U/M	1-17	18+
61091	Doz	10.36	10.12

Please check our website at www.kcda.org - Click on the gold button and login to Supply Link for the most current listing of products and pricing. Pricing in this catalog are as of the printing date and are subject to change without notice.

BOCCE BALLS

G) Bocce Lawn Bowling Set

This set includes 8 resin balls (2 each red, blue, green and yellow), 1 pallina (40 mm). A durable plastic carrying case with rugged nylon ball-bearing wheels and handle that measures 5-1/2" wide x 37-3/4" high x 4-1/4" deep. Qualifying Standard: Gopher.

KCDA No.	U/M	1-23	24+
61157	9/Set	92.93	91.43

BOWLING

H) Cramer Bowling Ball

Hard rubber, 5 pounds, three finger. Cramer 527, No Substitute.

KCDA No.	U/M	1-7	8+
61215	Ea	43.30	42.60

I) Cramer Bowling Pins

Plastic, full size, weighted. Cramer 21071, No Substitute.

KCDA No.	U/M	1-7	8+
61180	10/Set	57.56	56.63

J) Cramer Bowling Set

Includes one 5 pound, three finger ball, ten regulation size pins, weighted. Cramer 21070, No Substitute.

KCDA No.	U/M	1-5	6+
61161	Ea	103.56	101.89

BULLHORNS

K) Bullhorn/Megaphone

800 yard range megaphone, weatherproof, 20 watts peak - 16 watts rated, signal alarm switch, pistol trigger switch, volume control, carrying strap, bell diameter 9", length 15", uses 8 - "C" batteries- not included see KCDA No. 29653. Qualifying Standard: Fanon.

KCDA No.	U/M	1-11	12+
61134	Ea	159.46	156.89

L) Fanon Magaphone

600 yard range bullhorn, weatherproof, high impact ABS plastic bell, industrial and recreational application, pistol trigger talk switch, 16 watts peak - 10 watts rated, volume control, carrying strap, bell diameter 7", length 14", uses 6 - "C" batteries- not included see KCDA No. 29653. Fanon MV10S, No Substitute.

KCDA No.	U/M	1-11	12+
61132	Ea	128.69	126.61

2011 KCDA CATALOG

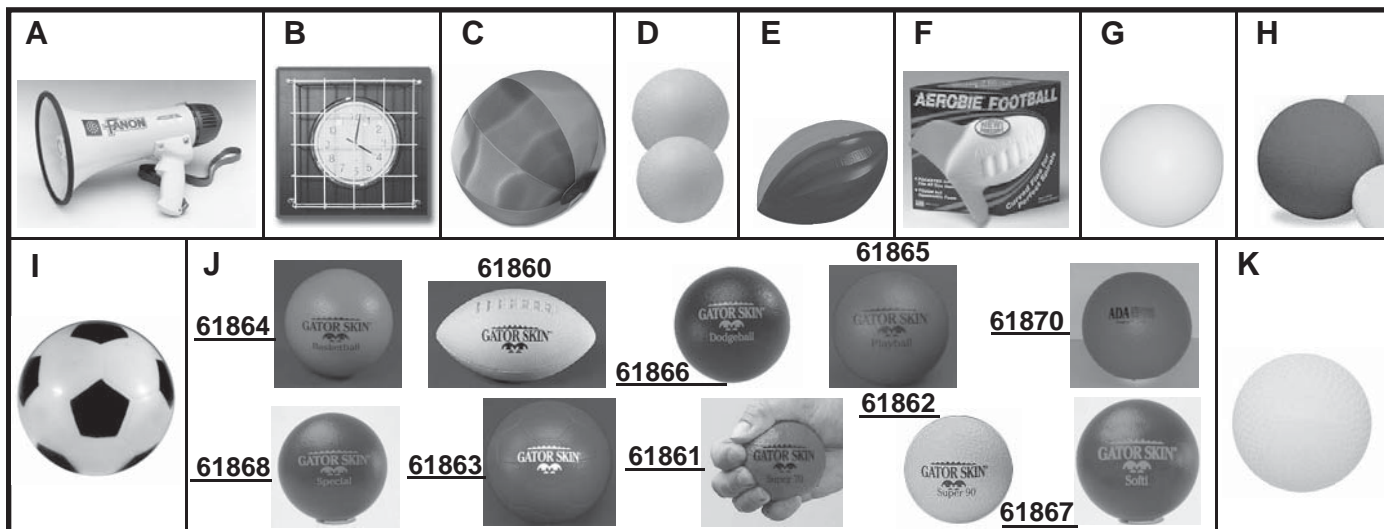

A) Fanon Megaphone

300 yard range bullhorn, weatherproof, high impact ABS plastic bell, built-in microphone, trigger talk switch, 10 watts peak – 5 watts rated, volume control, carrying strap, bell diameter 7-1/2", length 12-3/4", uses 8 – "AA" batteries- not included see KCDA No. 29652. Fanon MP5, No Substitute.

KCDA No.	U/M	1-11	12+
61130	Ea	93.50	91.99

CLOCK GUARD

B) Clock Guard

White rust resistant steel wire to protect gym clocks. 16" high x 16" wide x 5" deep. Hardware not included. Qualifying Standard: TC Sports.

KCDA No.	U/M	1-5	6+
63235	Ea	30.48	29.74

ELEMENTARY ACTIVITIES / BALLS / CAGE/BLADDERS/COVERS

C) Cage Ball

Complete butyl bladder, #10 canvas duck cover, all seams double sewn, 100% nylon stitching, leather laced. Includes cage ball and bladder. Qualifying Standard: BSN.

KCDA No.	Size	U/M	1-5	6+
61103	36"	Ea	40.86	40.20

Cage Ball Bladders

For cage ball. Qualifying Standard: BSN.

KCDA No.	Size	U/M	1-5	6+
61113	36"	Ea	24.80	24.40

ELEMENTARY ACTIVITIES / BALLS / FOAM

D) Foam Fabricated Safety Balls

For use with safety bats. Qualifying Standard: Champion.

KCDA No.	Size	U/M	1-23	24+
61230	Baseball	Ea	1.77	1.75
61229	Softball	Ea	2.36	2.32

E) Football, Foam

Jr. size, foam rubber. Qualifying Standard: Poof.

KCDA No.	U/M	1-23	24+
61852	Ea	3.69	3.63

F) Football, Foam

Foam with turbo fins, finger grips. Qualifying Standard: Aerobee.

KCDA No.	U/M	1-23	24+
61849	Ea	11.43	11.25

G) Poof Volleyball, Foam Rubber

For elementary use, indoor. Poof 400, No Substitute.

KCDA No.	U/M	1-23	24+
61853	Ea	5.74	5.65

H) Round Foam Rubber Balls

Indoor lightweight synthetic foam rubber balls, uncoated. Ideal for nerf-type games. No color choice. Qualifying Standard: BSN.

KCDA No.	Size	U/M	1-47	48+
62780	3"	Ea	0.57	0.56
62786	4"	Ea	0.85	0.84
62788	7"	Ea	4.00	3.94

I) Soccer Ball, Nerf

Nerf-type, junior size, tough protective skin, non toxic foam colored panels. Qualifying Standard: Champion.

KCDA No.	U/M	1-11	12+
63030	Ea	7.92	7.61

ELEMENTARY ACTIVITIES / BALLS / RHINO/GATER SKIN

J) Coated Foam Skin Balls

Tear-resistant, washable and can be used in any weather, no color choice, 3 year warranty. Qualifying Standard: Gator Skin, ADA.

KCDA No.	Desc	U/M	1-23	24+
61864	Basketball, 9"	Ea	11.63	11.44
61860	Football, Jr	Ea	8.73	8.59
61866	Playball, 6"	Ea	6.09	5.99
61865	Playball, 6-1/2"	Ea	6.86	6.75

KCDA No.	Desc	U/M	1-11	12+
61870	Playball, 7"	Ea	9.30	9.15

KCDA No.	Desc	U/M	1-23	24+
61868	Playball, 8-1/4", Hi Bounce	Ea	10.95	10.77
61863	Soccerball, 7-1/4"	Ea	9.18	9.03
61861	Softball, 2-3/4" Med Bounce	Ea	2.38	2.34
61862	Softball, 3-1/2"	Ea	2.83	2.78
61867	Softi, 6", Med Bounce	Ea	6.10	6.00

ELEMENTARY ACTIVITIES / BALLS / RUBBER

K) Baden Utility Ball

Composition rubber cover, yellow precision wound, 2 ply Butyl bladder, 8", very durable. Baden UX850, No Substitute.

KCDA No.	U/M	1-23	24+
62801	Ea	5.38	5.26

Please check our website at www.kcda.org - Click the gold button and login to Supply Link for the most current listing of products and pricing. Pricing in this catalog are as of the printing date and are subject to change without notice.

2011 KCDA CATALOG

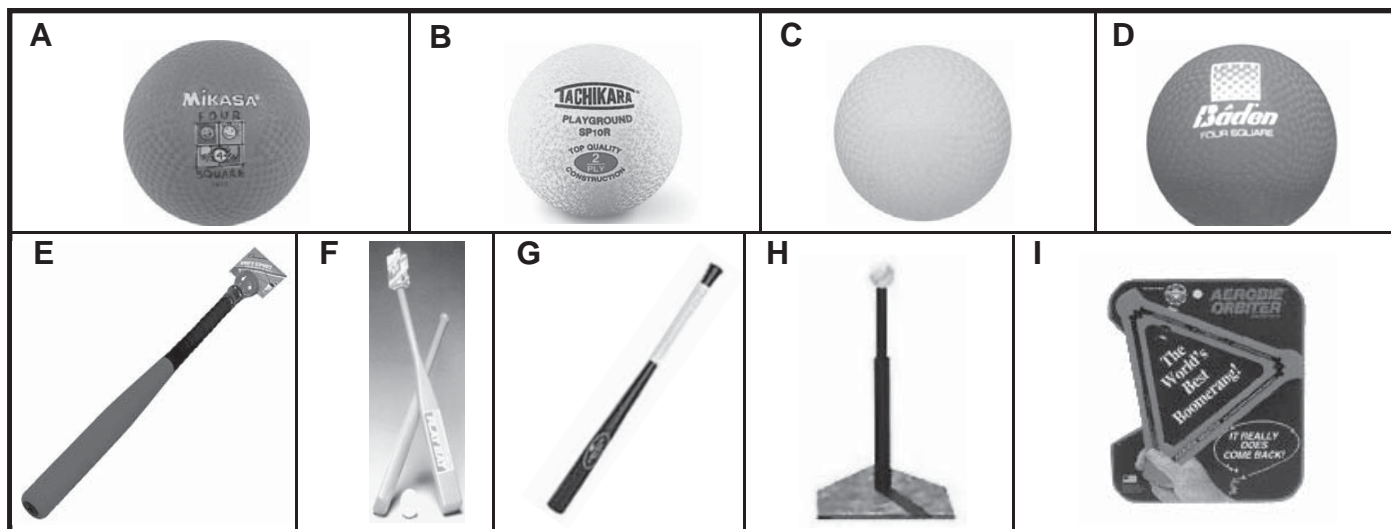

A) Mikasa Playground Balls - Latex Free

8.5" playground/four square balls by Mikasa have a new formulation that is latex free. 2 ply nylon wound. Inflation instructions on each ball, please do not over inflate. Mikasa, No Substitute.

KCDA No.	Mfg. No.	Color	U/M	1-35	36+
64379	PG8.5	Blue	Ea	4.32	4.25
64377	PG8.5	Lime	Ea	4.32	4.25
64380	PG8.5	Orange	Ea	4.32	4.25
64378	PG8.5	Purple	Ea	4.32	4.25
64375	PG8.5	Red	Ea	4.32	4.25
64376	PG8.5	Yellow	Ea	4.32	4.25

B) Playground Ball

Soft, resilient, highly visible, and triple protected against ozone and weathering. An anti-oxidant agent is added to the rubber compound to increase durability and prevent aging. 2-PLY construction method molds two separate membranes together to insure shape while creating a solid, more responsive feel with superior air retention and performance. Inflation instructions on each ball, please do not over inflate. Qualifying Standard: Tachikara.

KCDA No.	Size	U/M	1-47	48+
64384	10"	Ea	3.68	3.60

C) Playground Balls

Two-ply, yellow rubber. Inflation instructions on each ball, please do not over inflate. Qualifying Standard: Baden.

KCDA No.	Size	U/M	1-47	48+
62750	5"	Ea	2.01	1.96
62751	6"	Ea	2.15	2.10
62752	8-1/2"	Ea	2.51	2.46
62753	10"	Ea	4.06	3.97
62754	13"	Ea	6.58	6.42
62755	16"	Ea	7.94	7.75

D) Playground Balls

Two ply, red. Inflation instructions on each ball, please not over inflate. Qualifying Standard: Baden.

KCDA No.	Size	U/M	1-35	36+
64340	5"	Ea	2.04	2.01
64341	6"	Ea	2.18	2.15
64342	7"	Ea	2.27	2.24
64343	8-1/2"	Ea	2.55	2.51
64344	10"	Ea	4.13	4.06
64345	13"	Ea	6.68	6.58
64346	16"	Ea	8.06	7.94

ELEMENTARY ACTIVITIES / BATS

E) Bats, Foam

For elementary use. This bat is made with highly resilient foam-like rubber around a solid core. Ball included with bat. Qualifying Standard: Champion.

KCDA No.	Length	U/M	1-23	24+
61225	24"	Ea	8.48	8.34
61226	27"	Ea	9.23	9.08
61227	29"	Ea	9.69	9.53

F) Cosom Flat Bat

Plastic, includes ball. Cosom 001850, No Substitute.

KCDA No.	U/M	1-47	48+
63338	Ea	7.30	7.02

G) Cosom Plastic Softball Bat

Closed end, official size, 31", dowel pin in handle for added strength, black. Cosom MSCOS705, No Substitute.

KCDA No.	U/M	1-47	48+
63340	Ea	6.35	6.10

ELEMENTARY ACTIVITIES / BATTING TEE

H) Batting Tee

Adjustable hitting height from 22" to 47". Solid base prevents toppling. 12-1/2 lbs. For replacement sleeve see KCDA No. 60072. Qualifying Standard: BSN.

KCDA No.	U/M	1-7	8+
60771	Ea	14.26	14.03

Batting Tee Sleeve

Replacement inside tube for batting tee. Fits KCDA No. 60771. Qualifying Standard: BSN.

KCDA No.	U/M	1-7	8+
60772	Ea	2.46	2.42

ELEMENTARY ACTIVITIES / BOOMERANG

I) Boomerang

Boomerang orbiter. Qualifying Standard: Aerobee.

KCDA No.	U/M	1-47	48+
61206	Ea	7.54	7.43

Please check our website at www.kcda.org - Click on the gold button and login to Supply Link for the most current listing of products and pricing. Pricing in this catalog are as of the printing date and are subject to change without notice.

2011 KCDA CATALOG

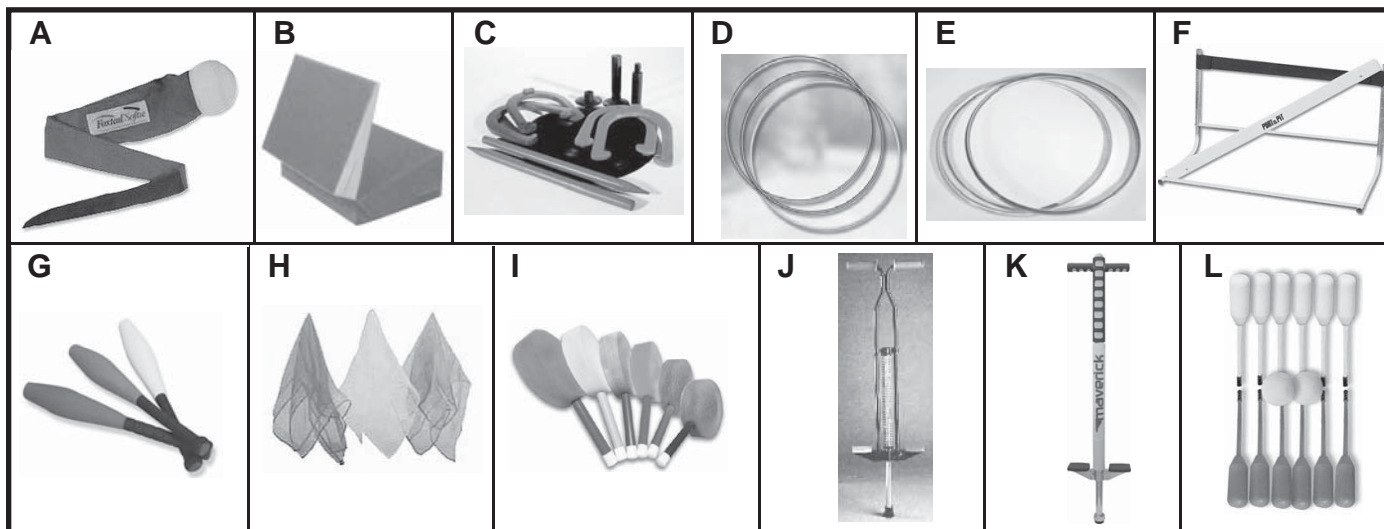

ELEMENTARY ACTIVITIES / FOXTAIL

A) Foxtail Softie Ball

Soft foam ball with 3' tri-color nylon sock. Qualifying Standard: Klutz.

KCDA No.	U/M	1-23	24+
61217	Ea	8.43	8.29

ELEMENTARY ACTIVITIES / GYMNASTIC MATS

B) Downhill Mat

Folding ability allows for wedge, mini-pit or spotting block, polyfoam, 18 ounce coated vinyl cover, multicolored. Qualifying Standard: BSN.

KCDA No.	Size	U/M	1-3	4+
62673	4	Ea	236.80	232.92

ELEMENTARY ACTIVITIES / HORSESHOES

C) Horseshoe Set

Indoor/outdoor set includes 4 rubber horseshoes, 2 rubber mats with peg and 2 wooden dowels. Qualifying Standard: Champion.

KCDA No.	U/M	1-5	6+
61219	8/Set	10.89	10.71

ELEMENTARY ACTIVITIES / HULA HOOPS

D) Cramer Hula Hoops

Plastic, heavy gauge. Cramer, No Substitute.

KCDA No.	Mfg. No.	Diameter	U/M	1-11	12+
62445	000520	24"	Doz	55.55	53.36
62446	000530	30"	Doz	61.77	59.34
62447	000536	36"	Doz	70.92	68.12

E) Hula Hoops, Deluxe "No-Kink"

Round, hollow, light weight hoop with extra thick walls to prevent kinking. assorted colors. Qualifying Standard: BSN.

KCDA No.	Size	U/M	1-11	12+
62450	24"	Doz	35.45	34.32
62451	30"	Doz	41.92	40.58
62452	36"	Doz	50.92	49.30

ELEMENTARY ACTIVITIES / HURDLE

F) Hurdle, Jr. Training

Adjusts from 22" to 30", rocker design, rights itself when knocked over. Wood crossbar and nylon gate with a velcro grip. Qualifying Standard: BSN.

KCDA No.	U/M	1-8	9+
61152	Ea	58.67	57.75

ELEMENTARY ACTIVITIES / JUGGLING

G) Juggling Clubs

Polyethylene foam, 19", textured neoprene foam handles. Qualifying Standard: Nasco.

KCDA No.	U/M	1-5	6+
61243	1/Set	44.45	43.40

H) Juggling Scarves

Nylon. Qualifying Standard: Champion.

KCDA No.	U/M	1-11	12+
61244	3/Set	2.28	2.24

ELEMENTARY ACTIVITIES / LOLLIPOP PADDLES

I) BSN Lollipop Paddles

For foam balls, 8" diameter head and 7" imbedded handle, perfect for foam balls, fleece balls, shuttlecocks, ping-pong balls, etc. BSN 1008111, No Substitute.

KCDA No.	U/M	1-11	12+
61242	6/Set	36.22	35.63

ELEMENTARY ACTIVITIES / POGO STICKS

J) Pogo Stick, 160 Pounds

All metal construction, for children and adults weighing up to 160 pounds. Qualifying Standard: Master Pogo.

KCDA No.	U/M	1-5	6+
61238	Ea	36.69	36.10

K) Pogo Stick, 80 Pounds

For child up to 80pounds, T-handle. Qualifying Standard: Marverick.

KCDA No.	U/M	1-5	6+
61239	Ea	29.94	29.46

ELEMENTARY ACTIVITIES / POLO

L) Pillo Polo Spongie

Contains 12 - flexible polysticks with a 4" diameter foam head with rounded ends: six, red; six, yellow; one soft polyurethane ball. Pillo Polo 9906, No Substitute.

KCDA No.	U/M	1-11	12+
61212	13/Set	88.07	86.69

Please check our website at www.kcda.org - Click on the gold button and login to Supply Link for the most current listing of products and pricing. Pricing in this catalog are as of the printing date and are subject to change without notice.

2011 KCDA CATALOG

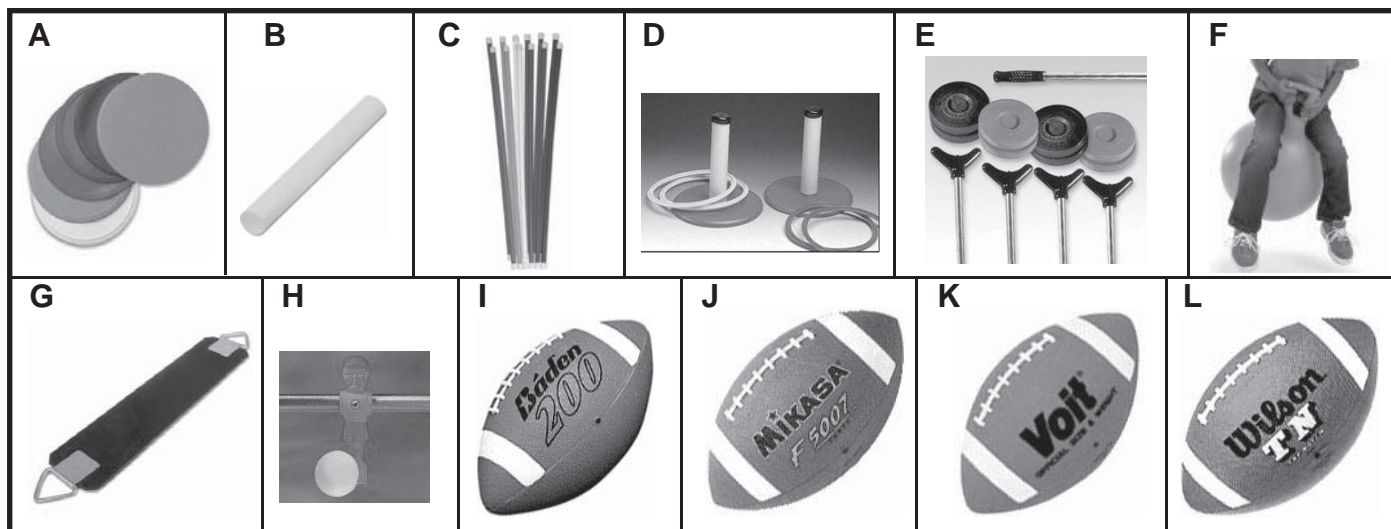

ELEMENTARY ACTIVITIES / POLY SPOTS

A) Poly Spots

9" diameter flat markers made of soft flexible plastic. Sticks to gym floor, without shifting. Qualifying Standard: BSN.

KCDA No.	Color	U/M	1-11	12+
61220	Assorted	12/Pkg	12.11	11.92
61221	Orange	12/Pkg	11.47	11.28

ELEMENTARY ACTIVITIES / RELAY BATONS

B) Plastic Relay Batons

For elementary track and field, round edges, light weight. Qualifying Standard: Champion.

KCDA No.	U/M	1-24	25+
61150	Ea	0.55	0.55

ELEMENTARY ACTIVITIES / RHYTHM WANDS

C) Rhythm Wands

Virtually indestructible, high gloss polyethylene wands. Balance them, twirl, tap or use for exercises. All grade levels. 36" x 3/4" diameter. Assorted colors. Qualifying Standard: Pull Buoy.

KCDA No.	U/M	1-23	24+
61245	Ea	3.67	3.61

ELEMENTARY ACTIVITIES / RING TOSS

D) Ring Toss Game

Durable red and yellow plastic, contains four rings and two bases. Qualifying Standard: Cosom.

KCDA No.	U/M	1-11	12+
61218	6/Set	10.71	10.45

ELEMENTARY ACTIVITIES / SHUFFLEBOARD

E) Shuffleboard Set

Includes four 66" aluminum cues, eight 6" plastic discs - 4 black and 4 red, and rules. For replacement discs see KCDA No. 61224. Qualifying Standard: Martin.

KCDA No.	U/M	1-5	6+
61223	12/Set	84.64	83.94

ELEMENTARY ACTIVITIES / SPRING BALL

F) Sportime Hop Along Spring Ball

For riders 6 years old and up. Rugged plug valves for faster installation. Closed handles make it easy to hang them for storage. Sportime HOP-55, No Substitute.

KCDA No.	U/M	1-5	6+
61237	Ea	28.55	28.09

ELEMENTARY ACTIVITIES / SWING SEAT

G) CSI Swing Seat

Slash proof, 6" molded rubber with spring steel core, heavy duty plated hardware. CSI 42001, No Substitute.

KCDA No.	U/M	1-35	36+
63410	Ea	14.11	13.78

FOOSBALL

H) Foosballs

Replacement, white, standard size. Qualifying Standard: Gopher.

KCDA No.	U/M	1-23	24+
61233	12/Pkg	3.39	3.31

FOOTBALL / BALLS / INTERMEDIATE

I) Baden Intermediate Size Footballs

Intramural and P.E. grain finish, white rubber lace, simulated sewn seams, replaceable all rubber needle-type valve, With full stripes. Baden F200, No Substitute.

KCDA No.	U/M	1-23	24+
61824	Ea	6.72	6.45

J) Mikasa Intermediate Size Football

Intramural and P.E. grain finish, white rubber lace, simulated sewn seams, replaceable all rubber needle-type valve, With full stripes. Mikasa F5007, No Substitute.

KCDA No.	U/M	1-23	24+
61822	Ea	6.77	6.50

K) Voit Intermediate Size Football

Intramural and P.E. grain finish, white rubber lace, simulated sewn seams, replaceable all rubber needle-type valve, With full stripes. Voit CF7S, No Substitute.

KCDA No.	U/M	1-23	24+
61821	Ea	4.17	4.10

L) Wilson Intermediate Size Football

Intramural and P.E. grain finish, white rubber lace, simulated sewn seams, replaceable all rubber needle-type valve, With full stripes. Wilson F1517, No Substitute.

KCDA No.	U/M	1-23	24+
61823	Ea	7.62	7.32

Please check our website at www.kcda.org - Click on the gold button and login to Supply Link for the most current listing of products and pricing. Pricing in this catalog are as of the printing date and are subject to change without notice.

2011 KCDA CATALOG

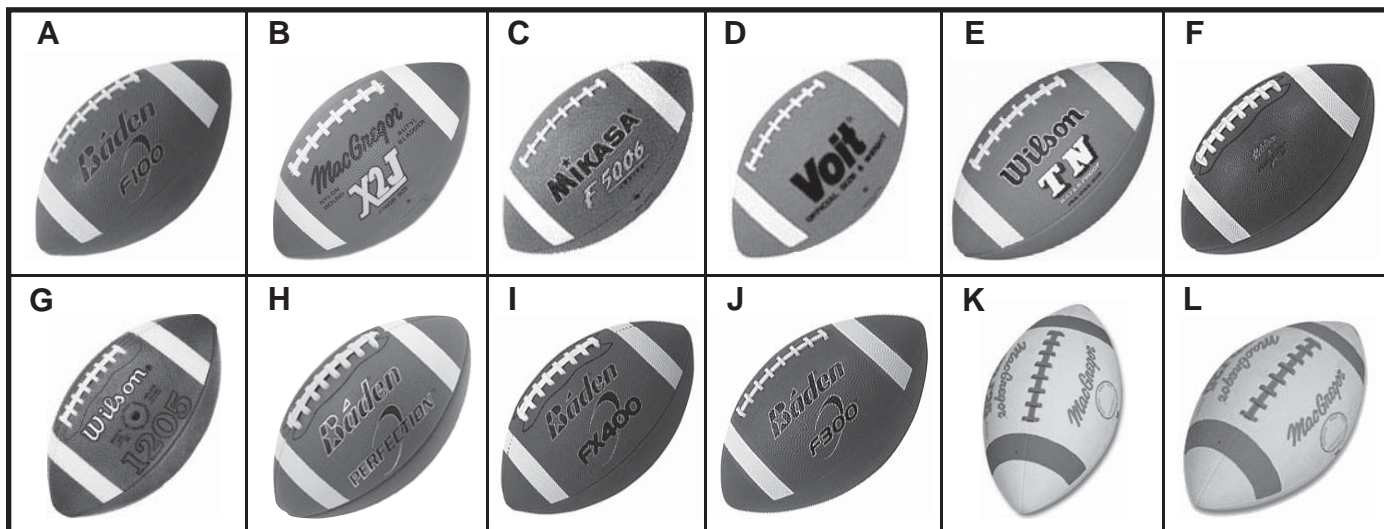

FOOTBALL / BALLS / JUNIOR

A) Baden Junior Rubber Football

Intramural and PE, pebble grain finish, white rubber lace, simulated sewn seams, replaceable all rubber needle-type valve, with full stripes. Baden F100, No Substitute.

KCDA No.	U/M	1-23	24+
61834	Ea	6.72	6.45

B) MacGregor Junior Playground Football

Junior size, pebble grain finish, white rubber simulated sewn seams, waterproof for play on any surface. MacGregor X2J, No substitute.

KCDA No.	U/M	1-11	12+
61840	Ea	4.34	4.27

C) Mikasa Junior Rubber Football

Intramural and PE, pebble grain finish, white rubber lace, simulated sewn seams, replaceable all rubber needle-type valve, with full stripes. Mikasa F5006, No Substitute.

KCDA No.	U/M	1-23	24+
61832	Ea	6.72	6.45

D) Voit Junior Rubber Football

Intramural and PE, pebble grain finish, white rubber lace, simulated sewn seams, replaceable all rubber needle-type valve, with full stripes. Voit CF6S, No Substitute.

KCDA No.	U/M	1-23	24+
61830	Ea	3.99	3.93

E) Wilson Junior Rubber Football

Intramural and PE, pebble grain finish, white rubber lace, simulated sewn seams, replaceable all rubber needle-type valve, with full stripes. Wilson F1515, No Substitute.

KCDA No.	U/M	1-23	24+
61833	Ea	10.01	9.61

FOOTBALL / BALLS / LEATHER

F) Baden Leather Footballs

Top quality cowhide leather football Panels are bonded to waterproof, rubber-covered carcass, butyl rubber bladder, rubber impregnated nylon windings, official size, two half stripes, NFHS approved. This is the WIAA Adopted Ball. Baden F7000L, No Substitute.

KCDA No.	U/M	1-11	12+
64308	Ea	67.94	66.34

G) Wilson Leather Footballs

Top quality cowhide leather football panels are bonded to waterproof, rubber-covered carcass, butyl rubber bladder, rubber impregnated nylon windings, official size, two half stripes, NFHS approved. Wilson TDSF1205, No Substitute.

KCDA No.	U/M	1-11	12+
61792	Ea	54.68	53.80

FOOTBALL / BALLS / MICROFIBER COVER

H) Baden Microfiber Covered Football

Microfiber cover with waterproof liner, official size and weight game ball, NFHS approved stamp. Baden F700M Perfection, No Substitute.

KCDA No.	U/M	1-11	12+
62009	Ea	38.89	37.94

FOOTBALL / BALLS / RUBBER

I) Baden Rubber Football

Official size game ball with two full stripes, leather lacing, simulated sewn seams, replaceable all rubber needle-type valve, butyl bladder. Baden FX400, No Substitute.

KCDA No.	U/M	1-11	12+
61814	Ea	13.59	13.05

J) Baden Rubber Football

Official size, varsity, intramural and P.E., pebble grain finish, white rubber lace, simulated sewn seams, replaceable all-rubber needle-type valve, with full stripes. Baden F300, No Substitute.

KCDA No.	U/M	1-23	24+
61813	Ea	7.24	6.95

K) MacGregor Football

Official size yellow senior football. MacGregor X2L, No Substitute.

KCDA No.	U/M	1-23	24+
61846	Ea	4.59	4.51

L) MacGregor Rubber Footballs

Rubber covered footballs with nylon windings and butyl bladder construction. Pebble grain exterior with raised laces and stripes. Official size, high visibility yellow. MacGregor MCX2725X, No Substitute.

KCDA No.	Description	U/M	1-23	24+
61827	Intermediate	Ea	4.59	4.51

2011 KCDA CATALOG

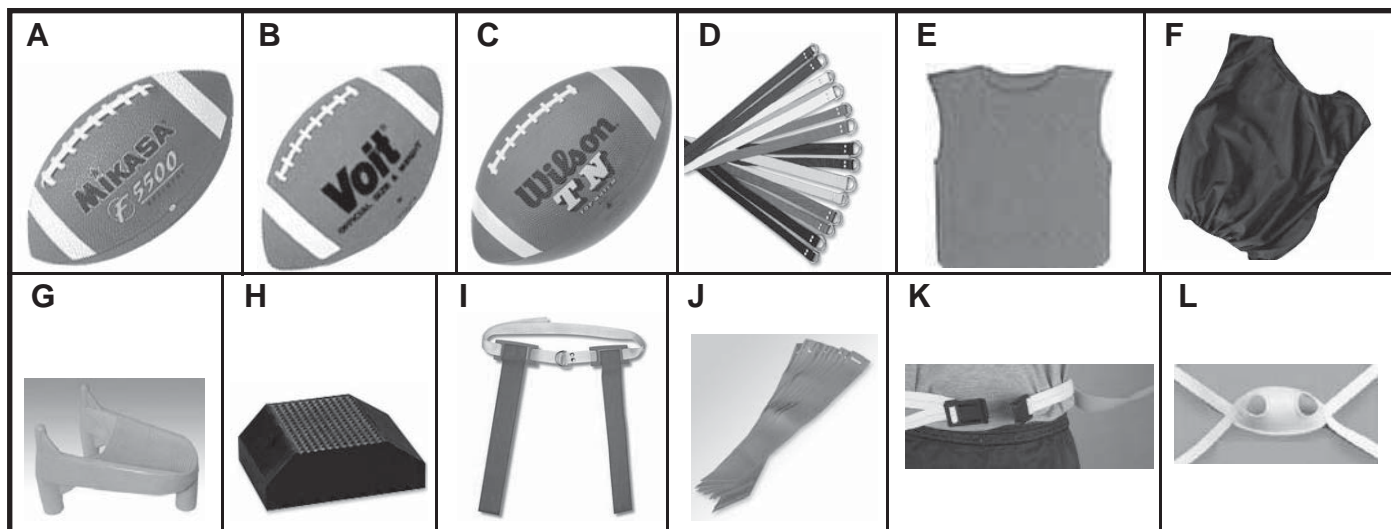

A) Mikasa Rubber Football

Official size game ball with two full stripes, leather lacing, simulated sewn seams, replaceable all rubber needle-type valve, butyl bladder. Mikasa F5500, No Substitute.

KCDA No.	U/M	1-11	12+
61802	Ea	12.69	12.39

B) Voit Rubber Football

Official size, varsity, intramural and P.E., pebble grain finish, white rubber lace, simulated sewn seams, replaceable all-rubber needle-type valve, with full stripes. Voit CF9S, No Substitute.

KCDA No.	U/M	1-23	24+
61815	Ea	4.65	4.57

C) Wilson Rubber Football

Official size, varsity, intramural and P.E., pebble grain finish, white rubber lace, simulated sewn seams, replaceable all-rubber needle-type valve, with full stripes. Wilson F1511X, No Substitute.

KCDA No.	U/M	1-23	24+
61811	Ea	10.45	10.04

FOOTBALL / CLOTHING / BELTS

D) Football Belts

1", heavy duty polypropylene web with heat sealed ends to prevent fraying. Nickel-plated D-rings, double riveted, 46" long. Qualifying Standard: Athletic Specialties.

KCDA No.	Color	U/M	1-39	40+
61706	Gold	Ea	0.94	0.93
61700	White	Ea	0.94	0.93

FOOTBALL / CLOTHING / SHIRTS

E) Russell Fishnet Scrimmage Shirts

Nylon fishnet, no sleeves, one size fits all. Russell, No Substitute.

KCDA No.	Color	Mfg. No.	U/M	1-47	48+
61061	Blue, Royal	12756	Ea	7.57	7.45
61063	Gold	12756	Ea	7.57	7.45
61062	Green, Kelly	12756	Ea	7.57	7.45
61060	Scarlet	12756	Ea	7.57	7.45

F) Scrimmage Vests

Lightweight and versatile design with a 100% nylon micro mesh construction, youth. Qualifying Standard: Gopher.

KCDA No.	Color	U/M	1-23	24+
61066	Blue, Royal	Ea	2.51	2.47
61067	Green	Ea	2.51	2.47
61065	Red	Ea	2.51	2.47
61068	Yellow	Ea	2.51	2.47

FOOTBALL / FIELD EQUIPMENT / TEE

G) Kick-Off Tee

2" orange rubber. Qualifying Standard: Cannon Sports.

KCDA No.	U/M	1-23	24+
61788	Ea	1.69	1.66

H) Place-Kick Tee

2". Qualifying Standard: BSN.

KCDA No.	U/M	1-23	24+
61789	Ea	1.52	1.50

FOOTBALL / FLAG FOOTBALL

I) Flag Football Belts

Yank-a-flag, belt, strap, flags come off. One size fits all, nylon, adjustable. No hooks, snaps, buttons, toggles or flag knots. Qualifying Standard: Athletic Specialties.

KCDA No.	Color	U/M	1-5	6+
61605	Scarlet	Doz	13.11	12.80
61609	Yellow	Doz	13.11	12.80

J) Flags, Football Belts

Extra for yank-a-flag. Flag and belt tab included. Qualifying Standard: Athletic Specialties.

KCDA No.	Color	U/M	1-23	24+
61622	Scarlet	Doz	3.96	3.87
61624	Yellow	Doz	3.96	3.87

K) Rip Flag Belts

One piece, quick release, belt and flags come off. Rip Flag, No Substitute.

KCDA No.	Size	Color	U/M	1-23	24+
61648	Medium	Blue	Ea	5.26	5.13
61649	Large	Blue	Ea	5.26	5.13
61640	Medium	Red	Ea	5.34	5.26
61641	Large	Red	Ea	5.34	5.26
61644	Medium	Yellow	Ea	5.34	5.26
61645	Large	Yellow	Ea	5.34	5.26

FOOTBALL / PROTECTIVE GEAR / CHIN STRAP

L) Bike Jaw High Hook Up Chin Strap

Four point, bite. Bike BCS9, No Substitute.

KCDA No.	U/M	1-23	24+
61784	Ea	4.57	4.50

2011 KCDA CATALOG

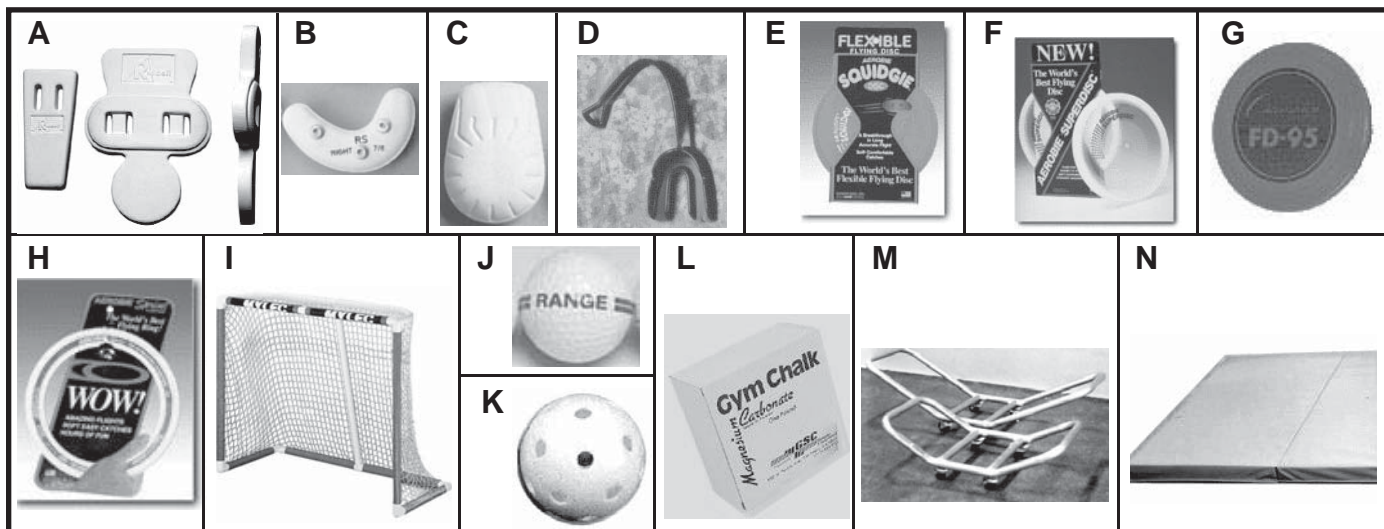

FOOTBALL / PROTECTIVE GEAR / HIP PADS

A) Riddell Hip Insert Pads

Long cut. Riddell 48117, No Substitute.

KCDA No.	U/M	1-11	12+
61749	Set	9.69	9.53

FOOTBALL / PROTECTIVE GEAR / JAW PADS

B) Jaw Pads

Universal, to fit any helmet, 1" thick. Qualifying Standard: AHL.

KCDA No.	U/M	1-23	24+
61727	Pair	5.91	5.82

FOOTBALL / PROTECTIVE GEAR / KNEE PADS

C) Knee Pads

8"x6"x3/8", shock absorbing, light weight. Qualifying Standard: Schutt.

KCDA No.	U/M	1-11	12+
61750	Pair	6.13	6.03

FOOTBALL / PROTECTIVE GEAR / MOUTH GUARD

D) Mouth Guards

With strap, teeth protectors. Qualifying Standard: Safe-T-Guard.

KCDA No.	Color	U/M	1-59	60+
66371	Black	Ea	0.44	0.43
66370	Clear	Ea	0.44	0.43

FRISBEEES

E) Flying Disc

Flying jelly disc. Qualifying Standard: Aerobee.

KCDA No.	U/M	1-23	24+
61203	Ea	4.20	4.14

F) Flying Disc

Flying super disc. Qualifying Standard: Aerobee.

KCDA No.	U/M	1-23	24+
61204	Ea	7.19	7.07

G) Flying Disc

9" diameter disc, assorted colors. Qualifying Standard: BSN.

KCDA No.	U/M	1-24	25+
61216	Ea	1.65	1.63

H) Flying Ring

10 or 13". Qualifying Standard: Aerobee.

KCDA No.	Size	U/M	1-23	24+
61200	10"	Ea	5.73	5.64
61201	13"	Ea	7.49	7.38

GOAL, ALL SPORT

I) Goal with Net

All purpose with rugged PVC construction, withstands rough treatment. Perfect for soccer, lacrosse and Hockey 54"x44"x26", white. Qualifying Standard: Mylec.

KCDA No.	U/M	1-5	6+
61306	Ea	43.24	42.54

GOLF BALLS

J) Golf Balls

Range quality, used but playable, assorted brands. Stripe colors may vary. Qualifying Standard: CSI.

KCDA No.	U/M	1-23	24+
61892	Doz	7.22	7.11

K) Plastic Golf Balls

Whiffle ball type golf balls. Qualifying Standard: Champion.

KCDA No.	U/M	1-11	12+
61882	12/Pkg	2.12	2.08

GYMNASTICS / CHALK

L) Gymnastic Chalk

Magnesium carbonate. Qualifying Standard: BSN.

KCDA No.	U/M	1-55	56+
62250	Lb	6.86	6.70

GYMNASTICS / MAT TRANSPORTER

M) Mat Transporter

Easy one person load. 1-2/4" steel tubing and heavy duty one-man swivel casters. 4'6"x1'10", 800 pound capacity. Qualifying Standard: Olympia.

KCDA No.	U/M	1-5	6+
62370	Ea	154.25	151.78

GYMNASTICS / MATS / GYM

N) Gymnasium Mats

Fold-a-mats, 2" thick, 2' wide panels. High grade 7.5 lb. Bonded foam. For elementary use where a softer surface is desired but firm enough that it won't bottom out. Great for tumbling exercise. Indoor us. Qualifying Standard: Davis Athletic.

KCDA No.	Color	Size	U/M	1-7	8+
62352	Blue	4x8	Ea	229.36	225.60
62362	Blue	5x10	Ea	362.34	356.40
62360	Red	5x10	Ea	362.34	356.40

2011 KCDA CATALOG

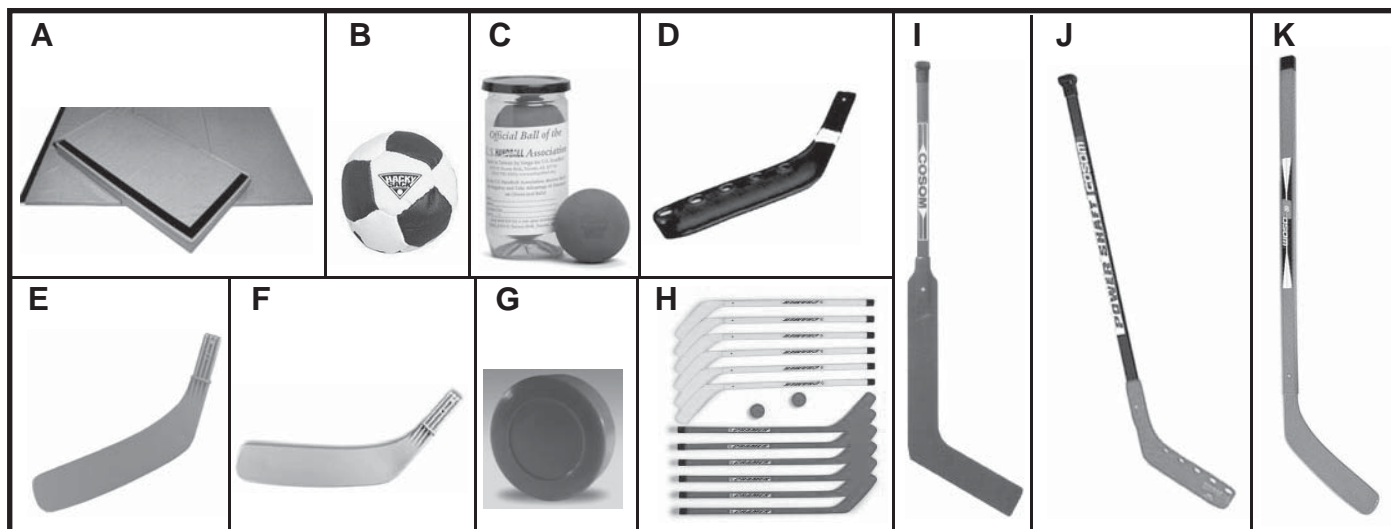

A) Gymnasium Mats

Fold-a-mats, 1-1/4" thick, 2' wide panels. A firmer mat, good for gymnastics, used by any age group through adult. Laminated closed cell, 2.2 pounds, polyethylene foam. Excellent shock absorbency, light weight, moisture resistant. Firm feel. Velcro on short ends. Qualifying Standard: Davis Athletic.

KCDA No.	Color	Size	U/M	1-5	6+
62322	Blue	4x8	Ea	214.72	211.20
62332	Blue	5x10	Ea	312.32	307.20
62320	Red	4x8	Ea	214.72	211.20

HACKY SACK

B) Hacky Sack

"Striker" official synthetic leather. Qualifying Standard: Whamo.

KCDA No.	U/M	1-23	24+
62397	Ea	3.41	3.36

HANDBALLS

C) Handballs

Rubber, approved by U.S. handball association, meets AAU and YMCA specifications. Qualifying Standard: USHA.

KCDA No.	U/M	1-35	36+
62395	2/Can	11.09	10.83

HOCKEY / BLADES

D) Cosom Hockey Blades

Street or gym hockey, replacement fits KCDA item 61322. Cosom, No Substitute.

KCDA No.	Color	Mfg. No.	U/M	1-35	36+
61327	Black	50839	Ea	3.35	3.30
61328	Orange	9651	Ea	3.42	3.37

E) Hockey Blade

Red replacement blade for KCDA No. 61309. Qualifying Standard: Cosom.

KCDA No.	U/M	1-35	36+
61312	Ea	3.16	3.11

F) Hockey Blade

Yellow replacement blade for KCDA No. 61311. Qualifying Standard: Cosom.

KCDA No.	U/M	1-35	36+
61313	Ea	3.16	3.11

HOCKEY / PUCKS

G) Shield Hockey Puck

Soft flexible plastic, 2-3/4" diameter, orange. Shield 9628, No Substitute.

KCDA No.	U/M	1-23	24+
61355	Ea	1.75	1.71

HOCKEY / SETS

H) Plastic Hockey Set

Includes 12 - 36" sticks, 2 - pucks, 1 - rule book, no goalie sticks, indoor and outdoor. Qualifying Standard: Cosom.

KCDA No.	U/M	1-7	8+
61301	Set	84.96	83.59

HOCKEY / STICKS

I) Cosom Goalie Stick

Street or gym hockey, 48" stick with a specially designed blade for hard use. Cosom, No Substitute.

KCDA No.	U/M	1-11	12+
61330	Ea	19.43	18.97

J) Hockey Stick and Blade

Street or gym hockey, official size: 47" long. Super Stick has high density fiberglass handle with replaceable polyethylene blade. Qualifying Standard: Cosom.

KCDA No.	Color	U/M	1-23	24+
61323	Black Blade	Ea	13.09	12.77
61322	Orange Blade	Ea	14.86	14.51

K) Hockey Sticks

Official style, for elementary age, 36" sticks, polyethylene, indoors or outdoors, rectangular. Qualifying Standard: Cosom.

KCDA No.	Color	U/M	1-23	24+
61309	Red	Ea	7.61	7.43
61311	Yellow	Ea	7.61	7.43

Please check our website at www.kcda.org - Click on the gold button to login to Supply Link for the most current listing of products and pricing. Pricing in this catalog are as of the printing date and are subject to change without notice.

2011 KCDA CATALOG

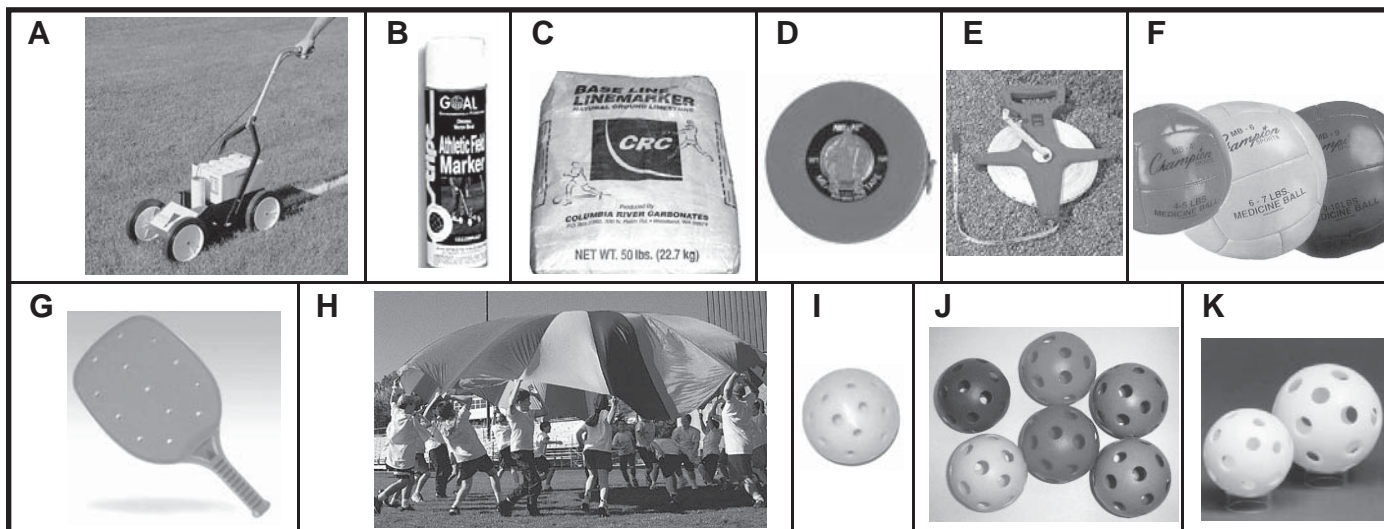

LINE MARKING / MARKERS

A) Line Marker, Spray Paint

For use on grass/dirt fields and for marking parking lots/lanes. Sturdy steel construction with 4 large easy rolling wheels. Lightweight housing includes windscreen, fingertip on/off lever, storage for 5 extra cans and simple 2" - 4" line width adjustment. Non-toxic aerosol spray goes straight downward for complete coverage. Maintenance free, no messy clean up. 1 year guarantee to be free of defects in workmanship or materials. For paint use KCDA No. 62607. Qualifying Standard: BSN.

KCDA No.	U/M	1-2	3+
67205	Ea	134.91	131.75

LINE MARKING / PAINT

B) Line Marking Paint

White line marking aerosol paint, 20oz., for KCDA No. 67205. Qualifying Standard: BSN.

KCDA No.	U/M	1-11	12+
62607	12/Case	44.10	43.38

LINE MARKING / WHITING

C) Linemarker Calcium Carbonate

Mineral whiting line marking material 50 lb. Use in KCDA No. 62701. Qualifying Standard: Linemarker Microna.

KCDA No.	U/M	1-47	48+
62606	Bag	3.39	3.34

MEASURING TAPE

D) Closed Reel Measuring Tape

Plastic coated fiberglass, resistant to water, won't crack or stretch, inches and feet on one side, centimeter and meters on the other side. Qualifying Standard: Athletic Specialties.

KCDA No.	Length	U/M	1-23	24+
63650	50 ft	Ea	3.67	3.58

E) Open Reel Measuring Tape

Plastic coated fiberglass, resistant to water, won't crack or stretch, inches and feet on one side, centimeter and meters on the other side. Qualifying Standard: Athletic Specialties.

KCDA No.	Length	U/M	1-5	6+
63651	50 ft	Ea	6.55	6.39

KCDA No.	Length	U/M	1-23	24+
63652	100 ft	Ea	5.32	5.20
63655	200 ft	Ea	9.55	9.39

MEDICINE BALLS

F) Champion Medicine Balls

Special blended filler, all seams are inverted and lock-stitched, leather cover. Champion, No Substitute.

KCDA No.	Size	Mfg. No.	U/M	1-7	8+
62460	4 to 5 Lbs	MB4	Ea	12.05	11.58
62461	6 to 7 Lbs	MB6	Ea	13.02	12.51
62462	8 to 9 Lbs	MB9	Ea	15.19	14.59
62463	11 to 12 Lbs	MB11	Ea	17.67	16.97

PADDLE BALL RACQUET

G) Paddle Ball Racquet

One piece molded plastic racquet, break-resistant, 12 ounce racquet with 11 holes in the face, red. Qualifying Standard: BSN.

KCDA No.	U/M	1-23	24+
62727	Ea	4.55	4.48

PARACHUTES

H) Parachutes

Nylon panels in alternating colors, heavily reinforced in all stress areas, central vent. Qualifying Standard: Huff.

KCDA No.	Size	U/M	1-11	12+
62537	12 feet	Ea	23.37	22.82
62536	24 feet	Ea	62.03	60.56

PICKLEBALL / BALL

I) Duraball Pickleballs

Official plastic baseball size pickleball. Duraball 56, No Substitute.

KCDA No.	U/M	1-47	48+
62715	Ea	1.79	1.75

J) Pickleball/Whiffle Balls

Assorted colors, plastic. Qualifying Standard: Champion, CSI or Champro.

KCDA No.	Size	U/M	1-23	24+
63260	12" Softball	Doz	7.04	6.87
62725	Baseball	Doz	8.00	7.81

K) Pickleball/Whiffle Balls

White, plastic. Qualifying Standard: Champro, CSI.

KCDA No.	Size	U/M	1-23	24+
62720	Baseball	Doz	5.18	5.06
63250	12" Softball	Doz	15.04	14.68

2011 KCDA CATALOG

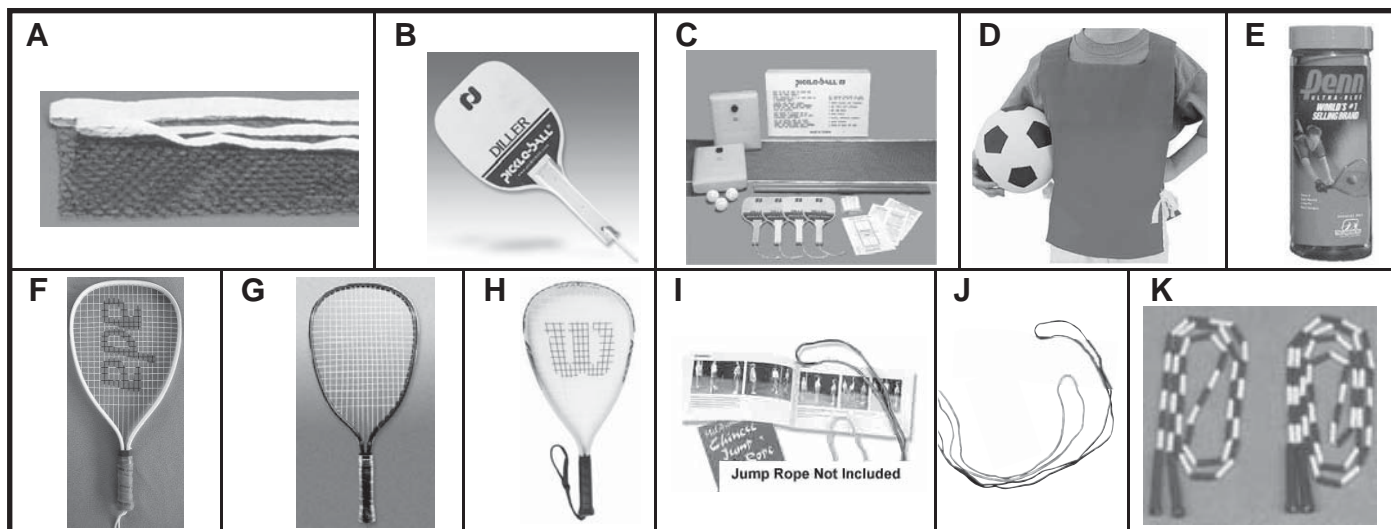

PICKLEBALL / NET

A) Diller Pickleball Net
Black, 21' x 2-1/2" x 1-1/4" poly rope thru 3" top of white binding. Diller 112, No Substitute.

KCDA No.	U/M	1-8	9+
62730	Ea	37.04	36.44

PICKLEBALL / PADDLE

B) Diller Pickleball Paddle
Natural birch, lacquer finish, 7 ply, 12 ounce, with strap, paddle head is 7-1/2" wide x 9" long. Diller 106, No Substitute.

KCDA No.	U/M	1-23	24+
62710	Ea	17.87	17.45

PICKLEBALL / SET

C) Diller Pickleball Set
Set includes portable standards, net, 4 paddles, 3 balls and rules. Diller 103, No Substitute.

KCDA No.	U/M	1-11	12+
62735	Set	158.59	155.99

PINNIES

D) Pinnies, Girls
Nylon, 22" long x 11-5/8" wide with a 24" expansion. Qualifying Standard: Snitz.

KCDA No.	Color	U/M	1-5	6+
61007	Blue	Doz	17.01	16.60
61006	Gold	Doz	17.01	16.60
61008	Green	Doz	17.01	16.60
61005	Red	Doz	17.01	16.60

RACQUETBALL / BALLS

E) Penn Ultra Blue Racquetballs
Official ball of the Tour of Legends. Blue rubber, 2-1/4" diameter. 3 balls per can. Penn Ultra Blue 551703, No Substitute.

KCDA No.	U/M	1-71	72+
62863	1/Can	3.78	3.64

Racquetballs

Blue rubber, 2-1/4" diameter. Qualifying Standard: Gopher Sports.

KCDA No.	U/M	1-23	24+
62862	Ea	1.96	1.88

RACQUETBALL / RACKET

F) ADA Star Racquetball Racket
Oversize aluminum head, ribbed grip, 16 gauge nylon strings. bumper guard. ADA Star 81, No Substitute.

KCDA No.	U/M	1-11	12+
62851	Ea	11.78	11.49

G) Racquetball Racket

Aluminum, one piece construction with plastic grommets, open throat, light weight, nylon strung, leather grip, with wrist strap. Qualifying Standard: ADA Star.

KCDA No.	U/M	1-11	12+
62850	Ea	8.64	8.30

H) Wilson Express Racquetball Racket

Titanium frame design, bright green. 210 gram weight, double beam construction. Wilson Express, No Substitute.

KCDA No.	U/M	1-11	12+
62852	Ea	8.64	8.30

ROPES / JUMP ROPES / CHINESE

I) Chinese Jump Rope Book

This book is 3-3/4" high x 7" wide with 12 activities and 72 illustrated photos. Chinese Jump Rope Not Included. Qualifying Standard: Sportime.

KCDA No.	U/M	1-11	12+
62567	Ea	4.43	4.36

J) Chinese Jump Ropes

Safe elasticized rope loops for eye-foot coordination. Rugged construction to hold up under school use. Qualifying Standard: Sportime.

KCDA No.	Length	U/M	1-11	12+
62560	8 Foot	Ea	1.71	1.69
62561	16 Foot	Ea	1.79	1.76

ROPES / JUMP ROPES / BEADED OVER NYLON

K) Jump Ropes

Beaded plastic segments over nylon cord. Assorted colors no choice. Qualifying Standard: Prostar.

KCDA No.	Length	U/M	1-47	48+
62530	7 Foot	Ea	0.91	0.89
62531	8 Foot	Ea	0.99	0.97
62532	9 Foot	Ea	1.07	1.04
62533	16 Foot	Ea	1.65	1.61

2011 KCDA CATALOG

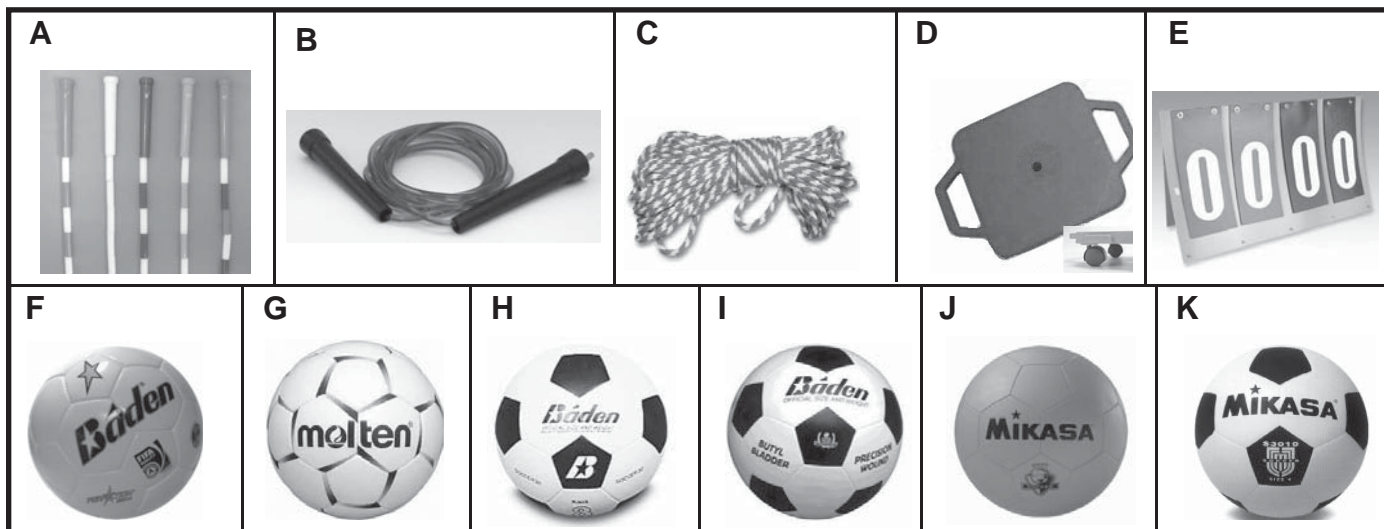

A) Ultra Speed Jump Ropes

Heavy duty rainbow beaded plastic segments over tough nylon cord. Excellent quality, made to last. Assorted colors, no choice. Ultra Speed Rope, No Substitute.

KCDA No.	Length	U/M	1-47	48+
62526	7 Ft.	Ea	4.00	3.91
62527	8 Ft.	Ea	4.32	4.22
62528	9 Ft.	Ea	4.64	4.53
62529	10 Ft.	Ea	4.95	4.84
62534	14 Ft.	Ea	6.10	5.95

ROPES / JUMP ROPES / LICORICE

B) Licorice Jump Ropes

Very durable, cords do not get twisted and tangled. All ropes are easily adjustable to your specific length. No Color Choice. Qualifying Standard: Ultra Speed Ropes.

KCDA No.	Size	U/M	1-47	48+
62521	7 Ft.	Ea	1.70	1.66
62522	8 Ft.	Ea	1.77	1.72
62523	9 Ft.	Ea	1.83	1.79
62524	10 Ft.	Ea	1.89	1.85
62525	14 Ft.	Ea	2.17	2.12

ROPES / JUMP ROPES / POLYETHYLENE

C) Jump Rope

#12 polyethylene cord, 3/8" x 100', solid braid. Qualifying Standard: Puritan.

KCDA No.	U/M	1-11	12+
62520	Hank	27.53	26.88

SCOOTERS

D) Cramer Scooters

12" polypropylene scooters with handles. Qualifying Standard: CSI.

KCDA No.	U/M	1-11	12+
63002	6/Ctn	103.90	102.26

SCORE KEEPING / UNIVERSAL FLIP & SCORE

E) CSI Flip and Score

Table top flip and score, for two teams, slotted tag holders to identify teams. Numbers are 5-3/4" high. Operated with red and blue vinyl flippers, 0 to 99. CSI 13020, No Substitute.

KCDA No.	U/M	1-8	9+
62913	Ea	22.71	22.35

SOCCER / BALLS / MICROFIBER COVER

F) Baden Microfiber Cover Soccer Ball

Microfiber cover with 4 ply lamination, hand sewn, latex bladder. FIFA approved stamp, WIAA state adopted ball. Baden Perfection Elite SX751, No Substitute.

KCDA No.	U/M	1-11	12+
63051	Ea	60.63	59.17

SOCCER / BALLS / PVC

G) Molten Soccer Ball

Hand stitched PU cover, 4-ply lamination backing, butyl bladder. Black on white. Molten PF160, No Substitute.

KCDA No.	Size	U/M	1-19	20+
63402	4	Ea	18.88	18.40

SOCCER / BALLS / RUBBER

H) Baden Rubber Soccerball

Black and white, elementary size K - 3rd grades, Baden S3030, No Substitute.

KCDA No.	Size	U/M	1-11	12+
63023	3	Ea	5.88	5.65

I) Baden Rubber Soccerballs

32 panel, black and white rubber cover, two-ply butyl bladder, nylon winding, with replaceable self-sealing valve. Baden, No Substitute.

KCDA No.	Mfg. No.	Size	U/M	1-23	24+
63024	S305	4	Ea	5.96	5.82
63025	S310	5	Ea	5.99	5.85

J) Mikasa Rubber Soccer/Kickball

Official size, rubber covered soccer/kick ball, natural rubber construction for good play and bounce. Mikasa S3030, No Substitute.

KCDA No.	Size	U/M	1-23	24+
63015	5	Ea	7.45	7.28

K) Mikasa Rubber Soccerball

32 panel, black and white rubber cover, two-ply butyl bladder, nylon winding, with replaceable self-sealing valve. Mikasa S3010, No Substitute.

KCDA No.	Size	U/M	1-23	24+
63019	4	Ea	6.46	6.31

2011 KCDA CATALOG

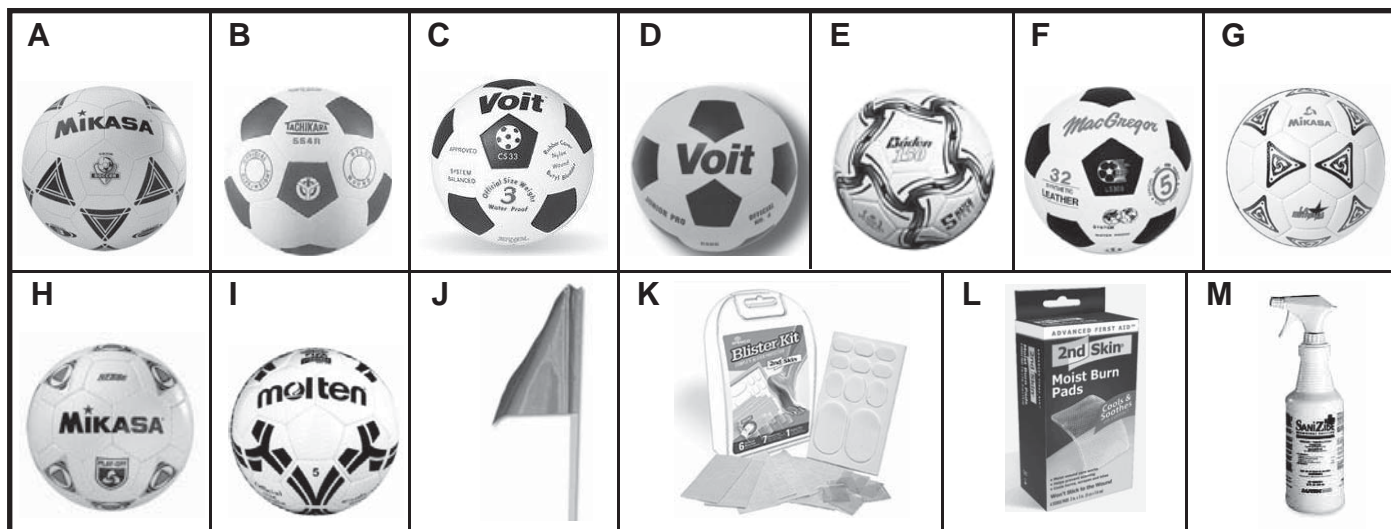

A) Mikasa Rubber Soccerball

Black and white, elementary size for K - 3rd grades. Mikasa S3008, No Substitute.

KCDA No.	Size	U/M	1-11	12+
63020	3	Ea	6.63	6.37

B) Tachikara Rubber Soccerballs

32 panel, black and white rubber cover, two-ply butyl bladder, nylon winding, with replaceable self-sealing valve. Tachikara, No Substitute.

KCDA No.	Mfg. No.	Size	U/M	1-23	24+
63018	SS4R	4	Ea	5.91	5.77
63016	SS5R	5	Ea	5.99	5.85

C) Voit Rubber Soccerball

Black and white, elementary size for K - 3rd grades. Voit CS77, No Substitute.

KCDA No.	Size	U/M	1-11	12+
63022	3	Ea	3.29	3.16

D) Voit Rubber Soccerballs

32 panel, black and white rubber cover, two-ply butyl bladder, nylon winding, with replaceable self-sealing valve. Voit, No Substitute.

KCDA No.	Mfg. No.	Size	U/M	1-23	24+
63035	CS66	4	Ea	3.52	3.38
63017	CS33	5	Ea	3.75	3.60

SOCCER / BALLS / SYNTHETIC

E) Baden Synthetic Soccer Balls

Black/white, scuff-proof, deluxe synthetic leather cover, waterproof, 32 panel, inspected by FIFA. Baden, No Substitute.

KCDA No.	Mfg. No.	Size	U/M	1-11	12+
63029	S140Z	4	Ea	7.71	7.41
63027	S150Z	5	Ea	7.71	7.41

F) MacGregor Synthetic Soccer Balls

Black/white, scuff-proof, deluxe synthetic leather cover, waterproof, 32 panel, inspected by FIFA. MacGregor, No Substitute.

KCDA No.	Mfg. No.	Size	U/M	1-11	12+
63033	LS606	4	Ea	8.06	7.75
63031	LS303	5	Ea	8.66	8.32

G) Mikasa Synthetic Soccer Balls

Black/white, scuff-proof, deluxe synthetic leather cover, waterproof, 32 panel, inspected by FIFA. Mikasa, No Substitute.

KCDA No.	Mfg. No.	Size	U/M	1-11	12+
63032	LE40	4	Ea	13.96	13.41
63028	LE50	5	Ea	14.47	13.90

H) Mikasa Synthetic Soccerball

Official game, hand stitched with 32 panels, red/black/silver. Mikasa PO Playoff, No Substitute.

KCDA No.	Size	U/M	1-11	12+
63042	5	Ea	21.18	20.35

I) Molten Synthetic Soccerball

White with black markings, multi-layer polyetherthane cover. Hand stitched, FIFA and NFHS approved. Molten CLF1000, No Substitute.

KCDA No.	Size	U/M	1-11	12+
63098	5	Ea	44.99	43.91

SOCCER / FIELD EQUIPMENT / FLAGS, CORNER

J) Corner Flags

Official flag, the PVC pole measures 1" in diameter x 60" high. The flag measures 14" high x 18" long. Qualifying Standard: BSN.

KCDA No.	U/M	1-3	4+
63066	4/Set	33.13	32.60

SPORTS MEDICINE / BLISTER KITS

K) Blister Kit

Contains 6 each of 3"x1-1/2" and 1 each of 3"x5" adhesive knit, 6 each 1" squares of 2nd skin dressing and 1 each 3"x5" sheet of pressure pad ovals, comes in resealable pouch. Spenco 49106, No Substitute.

KCDA No.	U/M	1-35	36+
65954	Ea	4.24	4.14

L) Spenco Second Skin Pads

These pads are made with pure sterile water, cools and soothes on contact, won't stick to wound. Individual packets, 1-1/2"x2". Spenco 47001, No Substitute.

KCDA No.	U/M	1-23	24+
65925	6/Box	4.73	4.69

SPORTS MEDICINE / BLOOD REMOVER

M) Blood Remover/Disinfectant

Virahol disinfectant has been proven to kill the viruses which cause HIV and tuberculosis. For hard surfaces and clothing. Qualifying Standard: Cramer.

KCDA No.	Size	U/M	1-23	24+
65947	1 Quart	Ea	16.20	15.94

2011 KCDA CATALOG



SPORTS MEDICINE / COLD PACKS/SPRAYS

A) Cold Pack

6" x 9", chemically activated. Qualifying Standard: Cramer.

KCDA No.	U/M	1-31	32+
65740	4/Box	4.89	4.77

B) Cold Spray

Skin coolant, fast temporary relief for athletes skin under extremely hot conditions. Non staining, nonflammable surface coolant. Qualifying Standard: Cramer.

KCDA No.	Size	U/M	1-23	24+
65745	12 ounce	Ea	10.97	10.80

SPORTS MEDICINE / EQUIPMENT CLEANER

C) Wrestling Mat and Pad Cleaner

Cleans, sanitizes, disinfects and deodorizes. One pint of Whizzer concentrate makes a gallon of full strength disinfectant. Qualifying Standard: Muller.

KCDA No.	Size	U/M	1-23	24+
66026	Gallon	Gal	39.88	38.94

SPORTS MEDICINE / FUNGICIDE

D) Fung-O-Spray

Germicidal and fungicidal, 4 ounce spray, for athlete's foot and other fungus infections, stainless and greaseless, fast drying and non-sticky. Cramer, No Substitute.

KCDA No.	U/M	1-35	36+
65940	Can	7.22	7.11

SPORTS MEDICINE / GERMICIDE

E) Nitrotan Germicide

For cuts, burns and abrasions. Reduces pain and aids in preventing infection of minor wounds, 8 ounce spray. Qualifying Standard: Cramer.

KCDA No.	U/M	1-35	36+
66045	Can	14.35	14.01

SPORTS MEDICINE / TAPE

F) Adhesive Cloth Tape

15 yards of cloth backing. Qualifying Standard: Unbleached = Andover, Bleached = 1st & Ten, Jaybird.

KCDA No.	Description	U/M	1-3	4+
66470	1-1/2", Bleached	32/Case	45.42	44.69
66465	1-1/2", Unbleached	32/Case	45.24	44.51
66515	2", Bleached	24/Case	40.30	39.65

G) Adhesive Water Resistant Tape

15 yard rolls, team pack, cloth backing, water resistant. Qualifying Standard: J&J.

KCDA No.	Width	U/M	1-3	4+
66477	1-1/2"	32/Case	46.08	45.34

H) Color Team Pack Tape

With bleached hospital grade back cloth, color fast dye will not bleed, 1-1/2" x 15 yards. Qualifying Standard: Mueller.

KCDA No.	Color	U/M	1-35	36+
66458	Black	32/Case	61.52	60.07

I) Flexi-Wrap Film on Roller

4" plastic self-adhering film on roller, each roll contains 650' of .80 mil film. Replaces elastic wraps at a fraction of the cost, makes wrapping a one-handed task. Provides compression while clear film allows inspection of injury, built in hand brake on roller makes tearing easier. Qualifying Standard: Cramer.

KCDA No.	U/M	1-11	12+
65985	6/Ctn	38.74	37.81

SPORTS MEDICINE / TAPE CUTTER/BLADES

J) Tape Cutter and Blades

Unbreakable nylon, heavy duty carbon steel blades. Qualifying Standard: Cramer.

KCDA No.	Description	U/M	1-47	48+
66500	Zip-Cut Tape Cutter	Ea	4.05	3.99
66501	Replacement Blades	10/Pkg	6.19	6.10

SPORTS MEDICINE / TOOTH SAVER

K) EMT Tooth Saver

Tooth preserver system. Helps protect knocked-out tooth from cell damage and dehydration. Can be safely stored in the pH balanced fluid up to 24 hours until replantation. EMT Tooth Saver, No Substitute.

KCDA No.	U/M	1-11	12+
65915	Ea	11.69	11.50

SPORTS MEDICINE / TRAINING KIT

L) Medi-Kit

Complete, heavy duty metal, allows storage of 10oz. aerosol cans, metal divider prevents cans from tipping over, 15"x9-3/4"x10-1/4". Qualifying Standard: Mueller.

KCDA No.	U/M	1-5	6+
65960	Ea	115.47	113.60

2011 KCDA CATALOG

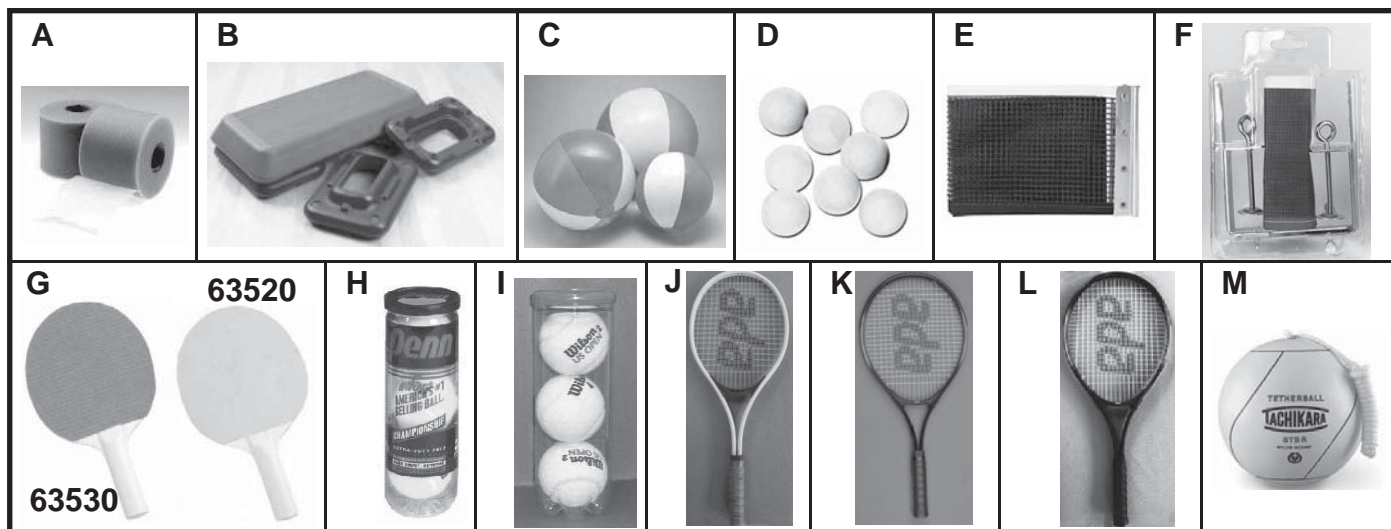

SPORTS MEDICINE / UNDERWRAP

A) Pre-Taping Underwrap

2-3/4" wide x 30 yard roll, paper thin polyurethane foam rubber, conforms to skin, chemically inert. Qualifying Standard: Mueller.

KCDA No.	U/M	1-5	6+
66510	48/Case	33.90	33.35
KCDA No.	U/M	1-143	144+
66511	Roll	0.74	0.71

STEPPERS

B) Stepper

Durable Polyethylene step is adjustable from 4" to 6" to 8" high. Set includes four 2" H platform risers and one 4" H bench. This bench has ribbed poly surface. Nonskid rubber floor pads ensure good stability. 29" L x 14" W x 4" H. Qualifying Standard: The Step.

KCDA No.	U/M	1-11	12+
62272	Ea	65.21	64.17

SWIM / BEACH BALLS

C) Sportime Beach Balls

Multi-colored. Qualifying Standard: Sportime.

KCDA No.	Description	U/M	1-11	12+
61400	16"	Ea	0.80	0.79
61401	20"	Ea	1.11	1.09
61402	24"	Ea	1.55	1.53
61403	36" - Heavy Duty	Ea	39.97	39.34

TABLE TENNIS / BALLS

D) Table Tennis Balls

Good quality. Qualifying Standard: CSI.

KCDA No.	U/M	1-23	24+
63511	6/Pkg	0.75	0.74

TABLE TENNIS / NETS / CLAMPS

E) Table Tennis Net

Metal sleeve end net, with top and bottom tape binding. Fits Markwort/Lion MTP3. KCDA No. 63541. Qualifying Standard: Markwort/Lion

KCDA No.	U/M	1-47	48+
63545	Ea	14.64	14.30

F) Table Tennis Net and Clamps

Metal sleeve end net with heavy steel extension net posts. Qualifying Standard: Markwort/Lion.

KCDA No.	U/M	1-47	48+
63541	Set	33.97	33.17

TABLE TENNIS / PADDLES

G) Table Tennis Paddles

5 ply construction. Qualifying Standard: Champion.

KCDA No.	Description	U/M	1-47	48+
63530	Rubber Pebbled	Ea	1.57	1.55
63520	Sandpaper	Ea	1.57	1.55

TENNIS / BALLS

H) Tennis Balls

Heavy duty championship. Used for long-life play on hard courts, optic yellow color. 3 balls per can. Qualifying Standard: Penn.

KCDA No.	U/M	1-47	48+
63605	1/Can	3.22	3.17

I) Wilson Practice Tennis Balls

Optic yellow, uniform size weight and rebound, 3 per can. Wilson 771019, No Substitute.

KCDA No.	U/M	1-47	48+
63610	1/Can	2.37	2.34

TENNIS / RACKETS

J) ADA Tennis Racket

Senior racquet, 105 square inches, tubular aluminum, triple braided nylon string, ribbed grip, white. ADA 60, No Substitute.

KCDA No.	U/M	1-11	12+
63620	Ea	18.73	18.00

K) ADA Tennis Racket

110 square inches, tubular aluminum, triple braided nylon string, ribbed grip, green and black. ADA 63, No Substitute.

KCDA No.	U/M	1-11	12+
63625	Ea	21.91	21.05

L) Aluminum Tennis Racket

First quality, with nylon strings, leather grip-non-slip, very durable. Qualifying Standard: ADA.

KCDA No.	U/M	1-11	12+
63626	Ea	14.60	14.26

TETHERBALL EQUIPMENT

M) Tachikara Tetherball

Top grade yellow rubber cover. Nylon cord included. Tachikara STBR, No Substitute.

KCDA No.	U/M	1-23	24+
63715	Ea	9.45	9.23

2011 KCDA CATALOG

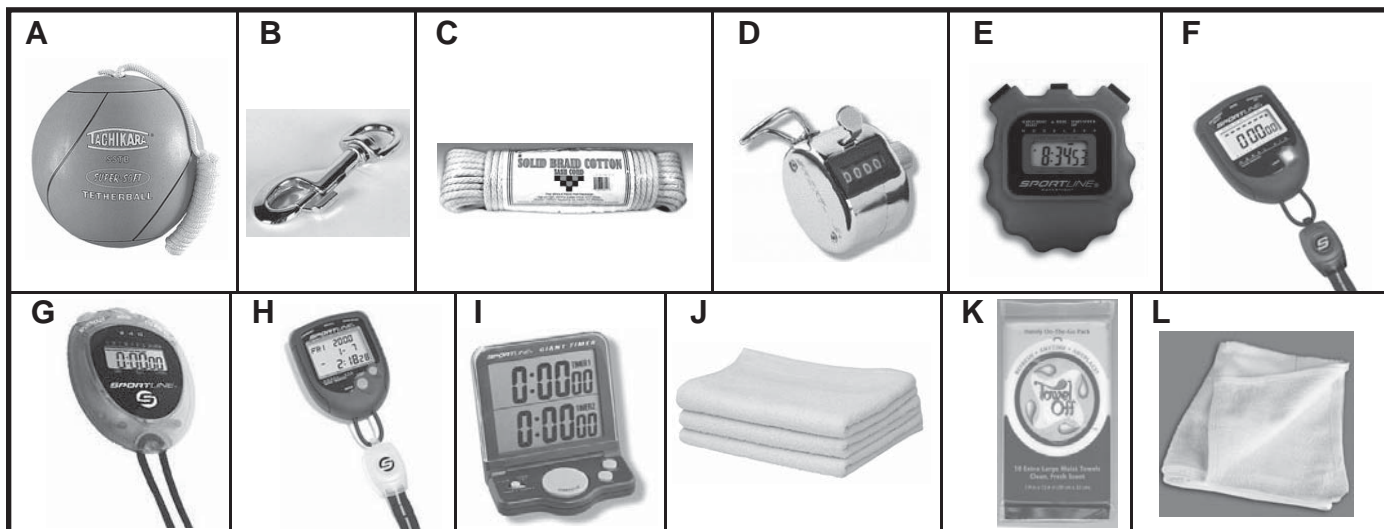

A) Tachikara Tetherball

Super soft blue, with nylon rope. Tachikara, No Substitute.

KCDA No.	U/M	1-23	24+
63711	Ea	10.77	10.52

B) Tetherball Attachment

Tetherball swivel, snap attachment. Qualifying Standard: CSI.

KCDA No.	U/M	1-11	12+
63732	Ea	1.37	1.34

C) Tetherball Cord

Nylon, 1/4" x 100', clip not included. Qualifying Standard: Aamstrand.

KCDA No.	U/M	1-23	24+
63742	Hank	19.11	18.66

TIMING DEVICES / HAND COUNTER

D) Hand Tally Counter

Chrome finish, four digit with finger ring, can be reset to zero with easy turnoff knob. Qualifying Standard: Sportline.

KCDA No.	U/M	1-23	24+
63769	Ea	4.61	4.50

TIMING DEVICES / STOP WATCHES

E) Digital Stopwatch

LCD display, one timing function, addition timer. Qualifying Standard: Sportline.

KCDA No.	U/M	1-5	6+
63748	Ea	8.95	8.81

F) Digital Stopwatch

Single event, LCD display, durable plastic cover. Qualifying Standard: Sportline.

KCDA No.	U/M	1-5	6+
63749	Ea	14.07	13.74

G) Quartz Display Stopwatch

Split timing function, lap/split/cumulative, with alarm. Qualifying Standard: Sportline.

KCDA No.	U/M	1-5	6+
63745	Ea	4.35	4.28

Please check our website at www.kcda.org - Click the gold button and login to Supply Link for the most current listing of products and pricing. Pricing in this catalog are as of the printing date and are subject to change without notice.

H) Stopwatch, 3 Line Display

Times start/stop or time-out events to ten hours, times, memorizes and recalls 100 cumulative and lap splits simultaneously to 1/100th of a second. Split release feature unlocks splits after five seconds to display current running lap time. Lap counter to 1,000 laps. Time, date and year clock with alarms. 12/24 hour option. Countdown timer sets from 24 hours to 1/10 of a second. Watertight to 100 feet. Low battery indicator and brightness adjuster. Qualifying Standard: Sportline.

KCDA No.	U/M	1-23	24+
26885	Ea	28.51	27.39

TIMING DEVICES / TABLE TOP

I) Table Timer

Giant 3"x2.5" two line display count down/count up timer for easy reading. Sets from 24 hours down to one second. Time-out feature with extra loud alarm. 12/24 hour clock. Qualifying Standard: Sportline.

KCDA No.	U/M	1-23	24+
63754	Ea	19.80	19.02

TOWELS

J) Terry Towels, Imported

20" x 40", white, minimum of 5 pounds per dozen, 100% cotton, sewn seams. Qualifying Standard: Venus.

KCDA No.	U/M	1-99	100+
63950	Doz	20.89	20.22

K) Towel Off Disposable Wipes

This product was designed as a shower alternative, it is made of a spun lace material and contains a fresh natural cleansing deodorant. The towel size 7.9"x12.6" wipes allow students and athletes to refresh anytime promoting good hygiene and appearance. The lightweight on the go pack fits neatly in a back packs, gym bags, purses, glove boxes or jacket pockets. Towel Off 50509, No Substitute.

KCDA No.	U/M	1-191	192+
50509	Ea	2.22	2.17

L) White Terry Towels, Domestic

20" x 40", white, 1/2" selvage both ends and sides, minimum of 5-1/2 pounds per dozen. Qualifying Standard: Venus.

KCDA No.	U/M	1-99	100+
63920	Doz	20.74	20.06

2011 KCDA CATALOG

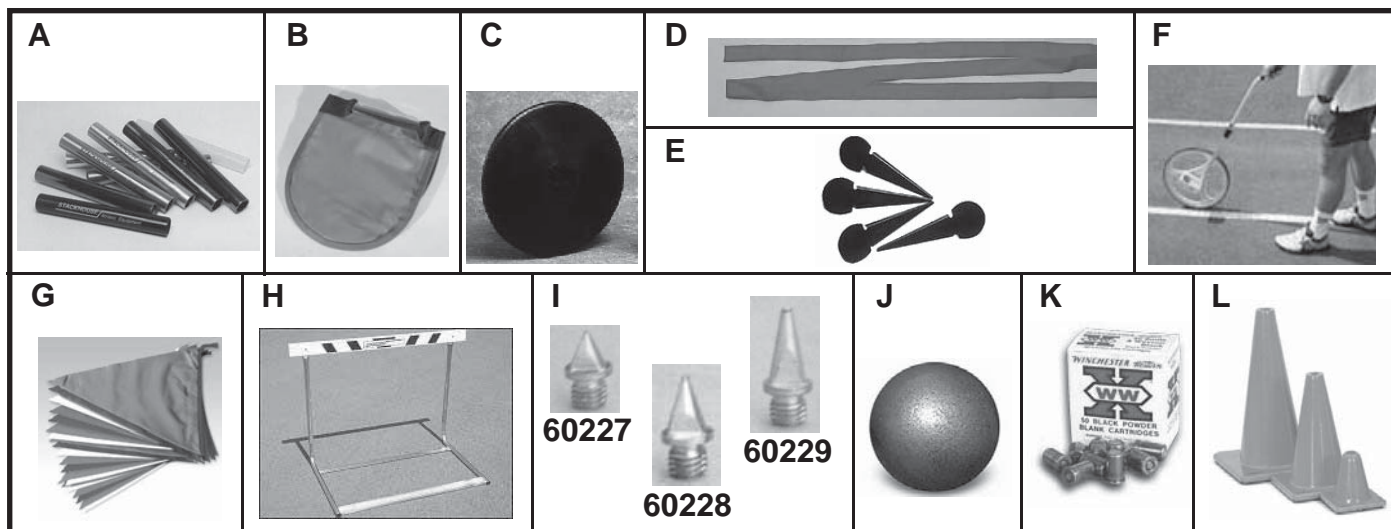

TRACK & FIELD / BATONS

A) Relay Batons

Aluminum. Qualifying Standard: Champion.

KCDA No.	Color	U/M	1-11	12+
60084	Black	Ea	1.71	1.69
60085	Blue	Ea	1.69	1.66
60086	Gold	Ea	1.69	1.66
60087	Green	Ea	1.69	1.66
60088	Red	Ea	1.69	1.66
60089	Silver	Ea	1.69	1.66

TRACK & FIELD / DISCUS

B) Carry Bag

For discus or shot put, vinyl. Qualifying Standard: Champion.

KCDA No.	U/M	1-11	12+
60083	Ea	5.90	5.81

C) Discus

Practice, rubber. Qualifying Standard: Stackhouse.

KCDA No.	Weight	U/M	1-11	12+
60136	1 Kilo	Ea	10.02	9.86
60137	1.6 Kilos	Ea	11.27	11.09

TRACK & FIELD / FIELD EQUIPMENT / CROSSBARS

D) Stackhouse Break Away Crossbar

Practice, nylon, hi-jump. Stackhouse TNTC, No Substitute.

KCDA No.	U/M	1-7	8+
60126	Ea	30.79	30.29

TRACK & FIELD / FIELD EQUIPMENT / DISTANCE MEASURING

E) Distance Markers

Contestant's name and number can be written on disc with chalk, durable and long lasting. Qualifying Standard: Stackhouse.

KCDA No.	U/M	1-11	12+
60143	12/Pkg	30.95	30.45

F) Stackhouse Measuring Wheel

36" aluminum wheel measures up to 9,999 feet with visible dial and quick reset. Rubber grip handle. Stackhouse CSI CTMW, No Substitute.

KCDA No.	U/M	1-3	4+
60242	Ea	93.72	92.23

TRACK & FIELD / FIELD EQUIPMENT / FLAG ROPES

G) Flag Ropes

100', plastic, for crowd control. Qualifying Standard: Stackhouse.

KCDA No.	U/M	1-11	12+
60140	Ea	8.06	7.94

TRACK & FIELD / FIELD EQUIPMENT / HURDLES

H) Stackhouse Hurdle

Official, adjustable, spring loaded. Meets NFHS standards. Stackhouse TRHL, No Substitute.

KCDA No.	U/M	1-11	12+
60142	Ea	110.31	108.55

TRACK & FIELD / FIELD EQUIPMENT / SPIKES

I) Spikes

Qualifying Standard: Blazer.

KCDA No.	Type	Size	U/M	1-11	12+
60227	Pyramid	1/4"	100/Bag	7.34	7.22
60228	Pyramid	3/8"	100/Bag	8.86	8.73
60229	Pyramid	1/2"	100/Bag	10.80	10.63

TRACK & FIELD / SHOT PUT

J) Stackhouse Shot Puts

Outdoor, Gray iron. Stackhouse, No Substitute.

KCDA No.	Weight	U/M	1-11	12+
60216	8 Lb	Ea	20.63	20.30
60218	12 Lb	Ea	32.50	31.98

TRACK & FIELD / STARTING PISTOL BLANKS

K) Starting Pistol Blanks

For starting pistols (KCDA Nos. 60199 and 60201) Qualifying Standard: Winchester.

KCDA No.	Description	U/M	1-23	24+
60202	22 Caliber	50/Box	14.96	14.73
60203	32 Caliber	50/Box	41.28	40.63

TRAFFIC CONES

L) Traffic Cones

Fluorescent orange traffic markers. Qualifying Standard: Poly.

KCDA No.	Height	U/M	1-23	24+
64249	6"	Ea	2.12	2.07
64250	12"	Ea	4.51	4.40
64251	18"	Ea	7.00	6.83

2011 KCDA CATALOG

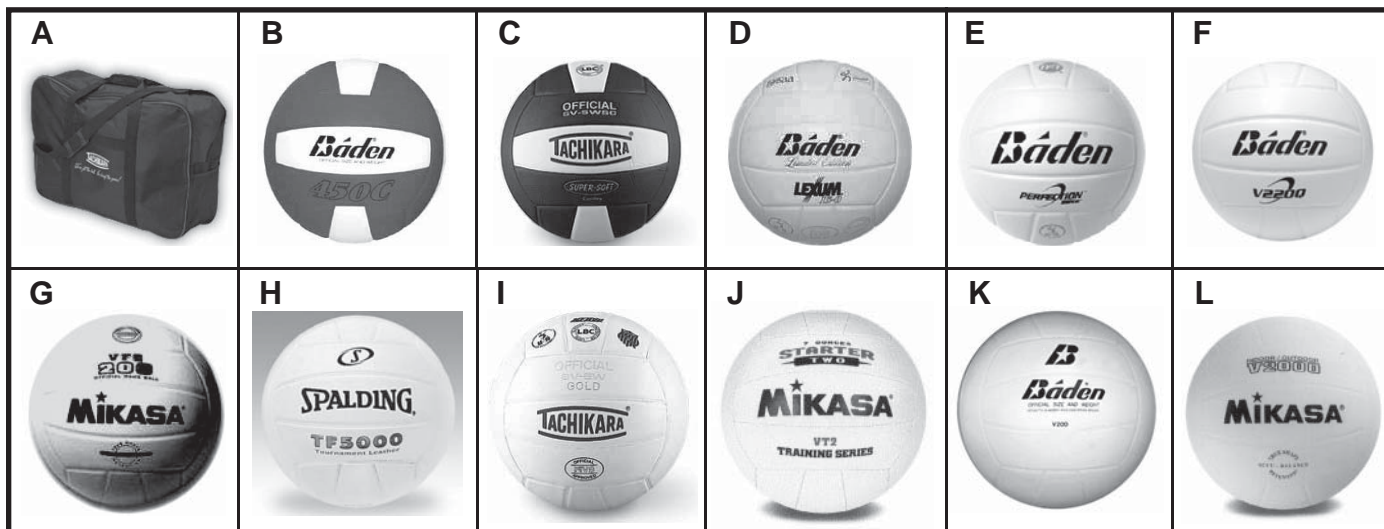

VOLLEYBALL / BAG

A) Volleyball Bag

Holds 6 balls, adjustable shoulder strap and velcro handles, black, 24"x8"x15.75", two mesh end pockets. Qualifying Standard: Tachikara.

KCDA No.	U/M	1-11	12+
64053	Ea	21.39	21.04

VOLLEYBALL / BALLS / COMPOSITE

B) Baden Composite Cover Volleyballs

Official size and weight, 18 panel, butyl bladder. Baden, No Substitute.

KCDA No.	Color	Mfg. No.	U/M	1-11	12+
64047	Green/White	VX450C	Ea	32.11	31.35

C) Tachikara Composite Cover Volleyballs

The material and construction of these balls offer a soft touch play. Constructed with a loose butyl bladder, the circumference is 25.6", the weight adjusts from 9.1 to 9.8 ounces and the cover is made with Sensi-Tec composite leather. Tachikara SV5WSC, No Substitute.

KCDA No.	Color	U/M	1-23	24+
64060	Black/White	Ea	28.02	27.57
64061	Purple/White	Ea	28.02	27.57
64066	Scarlet/White	Ea	28.02	27.57

VOLLEYBALL / BALLS / LEATHER

D) Baden Leather Game Volleyballs

Molded, 18 panel, tough and long lasting, double laminated butyl bladder, replaceable self-sealing valve, official size, weight and shape. Approved NFHS. Baden 15-0 No Substitute.

KCDA No.	Description	U/M	1-23	24+
64025	15-0	Ea	47.74	46.97

E) Baden Leather Volleyball

Official size, top grade, leather, butyl bladder. NFHS approved and WIAA adopted ball. Baden VX5E Perfection, No Substitute.

KCDA No.	U/M	1-23	24+
64073	Ea	49.59	48.79

F) Baden Leather Volleyball

Official game size ball. Full grain leather, soft valve system, butyl bladder. NFHS approved. Baden V220Q, No Substitute.

KCDA No.	U/M	1-23	24+
64028	Ea	33.78	32.45

G) Mikasa Leather Game Volleyball

Molded, 18 panel, tough and long lasting, double laminated butyl bladder, replaceable self-sealing valve, official size, weight and shape. Approved NFHS. Mikasa 6132, No Substitute.

KCDA No.	U/M	1-23	24+
64021	Ea	39.46	38.82

H) Spalding Leather Volleyball

Genuine leather, white, 2-ply soft cloth lining, floating butyl bladder, NFHS approved. Spalding TF5000, No Substitute.

KCDA No.	U/M	1-23	24+
64007	Ea	45.86	45.12

I) Tachikara Leather Game Volleyballs

Molded, 18 panel, tough and long lasting, double laminated butyl bladder, replaceable self-sealing valve, official size, weight and shape. Approved NFHS. Tachikara, No Substitute.

KCDA No.	U/M	1-23	24+
64023	Ea	41.83	41.15

VOLLEYBALL / BALLS / PRACTICE

J) Mikasa Synthetic Volleyballs

For indoor training use, choice of oversized or official size. Optic yellow synthetic leather cover. Mikasa, No Substitute.

KCDA No.	Size	Mfg. No.	U/M	1-17	18+
64041	Regular	VT1	Ea	13.94	13.62
64039	Oversize	VT2	Ea	14.97	14.62

VOLLEYBALL / BALLS / RUBBER

K) Baden Indoor-Outdoor Volleyball

Composition rubber cover, all white, super soft, official size, weight, 18 panel, double laminated butyl bladder. Baden V200, No Substitute.

KCDA No.	U/M	1-23	24+
64014	Ea	5.57	5.48

L) Mikasa Indoor-Outdoor Volleyball

Rubber cover, all white, super soft, official size, weight and shape, 18 panel, double laminated butyl bladder. Mikasa V2000, No Substitute.

KCDA No.	U/M	1-23	24+
64011	Ea	6.24	6.14

Please check our website at www.kcda.org - Click the gold button and login to Supply Link for the most current listing of products and pricing. Pricing in this catalog are as of the printing date and are subject to change without notice.

2011 KCDA CATALOG

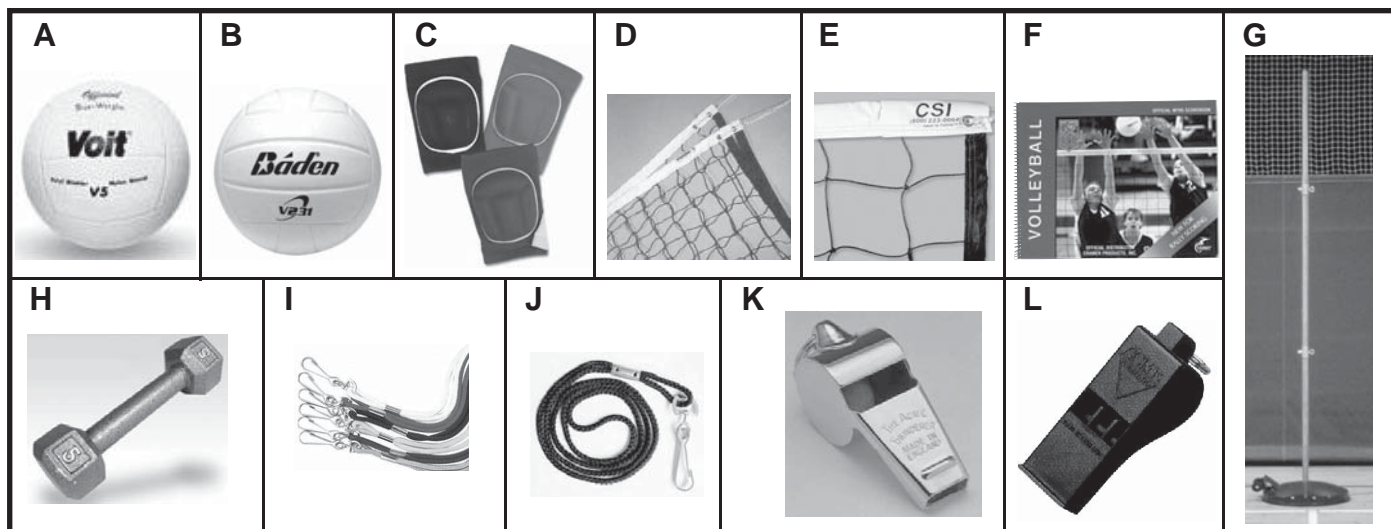

A) Voit Indoor-Outdoor Volleyball

Rubber cover, all white, super soft, official size, weight and shape, 18 panel, double laminated butyl bladder. Voit V5, No Substitute.

KCDA No.	U/M	1-23	24+
64013	Ea	4.34	4.27

VOLLEYBALL / BALLS / SYNTHETIC

B) Baden Synthetic Leather Volleyball

Durability of rubber and feel of leather, official size and weight, self-sealing replaceable valve, white, 18 panel, approved by national federation of state high schools. Baden V231, No Substitute.

KCDA No.	U/M	1-17	18+
64038	Ea	16.12	15.48

VOLLEYBALL / KNEE PADS

C) Volleyball Knee Pads

High stretch elastic knit, 9" long, 1 piece molded foam knee cap, washable. One size. Qualifying Standard: BSN.

KCDA No.	Color	U/M	1-11	12+
64058	Black	Pair	9.74	9.51
64056	Blue	Pair	9.74	9.51

VOLLEYBALL / NETS

D) Volleyball Net

Nylon yarn, steel cable through top and bottom, meets specifications of the rules For an official net, 32' x 3'. Qualifying Standard: MacGregor.

KCDA No.	U/M	1-29	30+
64040	Ea	28.95	28.02

E) Volleyball Net

Nylon yarn, weatherproofed 4" mesh, vinyl binding top and bottom, grommets at each end with nylon tie lines, 30' x 3'. Qualifying Standard: Prostar.

KCDA No.	U/M	1-29	30+
64045	Ea	13.93	13.48

VOLLEYBALL / SCOREBOOK

F) Cramer Girls Volleyball Scorebook

Girls. Cramer 191307R, No Substitute.

KCDA No.	U/M	1-23	24+
62905	Ea	10.26	10.10

VOLLEYBALL / STANDARDS / PADS

G) Stackhouse All Net Game Standard

For all net games, roll away, 30" base, transports on casters, rubber shod, 150 pounds. Stackhouse VAPR, No Substitute.

KCDA No.	U/M	1-11	12+
64325	Ea	420.22	416.77

WEIGHT LIFTING / DUMBBELLS

H) Dumbbells

Hex shaped, Qualifying Standard: ASCO.

KCDA No.	Weight	U/M	1-11	12+
60320	3 lb.	Ea	9.59	9.36
60321	5 lb.	Ea	10.84	10.58
60322	8 lb.	Ea	14.73	14.37
60323	10 lb.	Ea	18.13	17.69
60324	12 lb.	Ea	20.84	20.34
60325	15 lb.	Ea	25.63	25.01

WHISTLE LANYARDS

I) Whistle Lanyard

Assorted colors, 2 each of blue, red, white, black, green and gold. Approximately 19-1/2" long. Qualifying Standard: Champion.

KCDA No.	U/M	1-5	6+
64145	12/Pkg	3.19	3.11

J) Whistle Lanyard

Black braided nylon cord with plated swivel hook. Qualifying Standard: CSI.

KCDA No.	U/M	1-47	48+
64140	Ea	0.25	0.24

WHISTLES

K) Acme Nickel Whistle

#15 small nickel whistle. Acme 1385/12, No Substitute.

KCDA No.	U/M	1-11	12+
64120	Doz	67.82	66.22

L) Pea-Less Whistle

Official, carries over long distances, cuts through crowd noise. Water, dirt and cold resistant, extra loud. Qualifying Standard: Acme.

KCDA No.	U/M	1-11	12+
64125	12/Pkg	41.61	40.62

2011 KCDA CATALOG

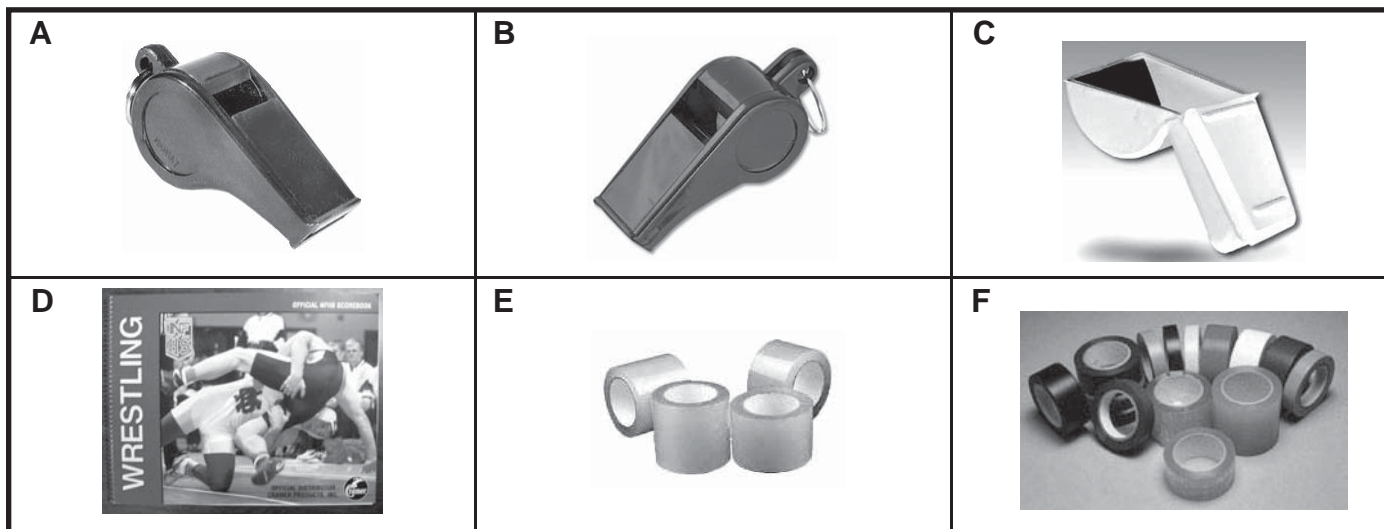

A) Plastic Whistle

Regulation. Qualifying Standard: Champion.

KCDA No.	U/M	1-35	36+
64100	Doz	3.56	3.51

B) Plastic Whistle

Small. Qualifying Standard: CSI.

KCDA No.	U/M	1-35	36+
64110	Doz	3.72	3.66

C) Whistle Guard

Rubber-tip guard for KCDA item 64120. Qualifying Standard: BSN.

KCDA No.	U/M	1-35	36+
64130	Doz	3.08	3.04

WRESTLING / SCOREBOOK

D) Wrestling Scorebook

Qualifying Standard: Cramer.

KCDA No.	U/M	1-23	24+
62912	Ea	10.26	10.10

WRESTLING / TAPE

Color Striping Tape

For helmet marking, marking gym floors and boundary markings on mats. Qualifying Standard: Champion.

KCDA No.	Size	Color	U/M	1-23	24+
60154	1/2"x108"	Green	Ea	1.10	1.09

E) Matman Mat Tape

Transparent vinyl, strong, does not split with continued use, 8 mil, leaves no residue when removed. Reusable, individually wrapped and waterproof. Matman, No Substitute.

KCDA No.	Size	Mfg. No.	U/M	1-23	24+
60194	2"x84"	75-2"	Ea	3.53	3.47
60195	3"x84"	75-3"	Ea	5.25	5.16
60196	4"x84"	75-4"	Ea	6.64	6.54

F) Matman Color Striping Tape

For helmet marking, marking gym floors and boundary markings on mats. Matman 45, No Substitute.

KCDA No.	Color	Mfg. No.	U/M	1-23	24+
1/2"x108"					
60158	Black	45	Ea	1.10	1.09
60166	Blue, Navy	45	Ea	1.10	1.09
60156	Blue, Royal	45	Ea	1.10	1.09
60157	Green, Kelly	45	Ea	1.10	1.09
60161	Orange	45	Ea	1.10	1.09
60163	Purple	45	Ea	1.10	1.09
60155	Red	45	Ea	1.10	1.09
60159	White	45	Ea	1.10	1.09
60160	Yellow	45	Ea	1.10	1.09
1"x108"					
60171	Black	45	Ea	2.16	2.13
60179	Blue, Navy	45	Ea	2.16	2.13
60169	Blue, Royal	45	Ea	2.16	2.13
60170	Green, Kelly	45	Ea	2.16	2.13
60174	Orange	45	Ea	2.16	2.13
60176	Purple	45	Ea	2.16	2.13
60168	Red	45	Ea	2.16	2.13
60172	White	45	Ea	2.16	2.13
60173	Yellow	45	Ea	2.16	2.13
2"x108"					
60184	Black	45	Ea	4.17	4.10
60192	Blue, Navy	45	Ea	4.17	4.10
60182	Blue, Royal	45	Ea	4.17	4.10
60183	Green, Kelly	45	Ea	4.17	4.10
60187	Orange	45	Ea	4.17	4.10
60181	Red	45	Ea	4.17	4.10
60185	White	45	Ea	4.17	4.10
60186	Yellow	45	Ea	4.17	4.10

Please check our website at www.kcda.org - Click the gold button and login to Supply Link for the most current listing of products and pricing. Pricing in this catalog are as of the printing date and are subject to change without notice.